

Roots 33 URAI Blower

Comparison with Eurus ZZ3M

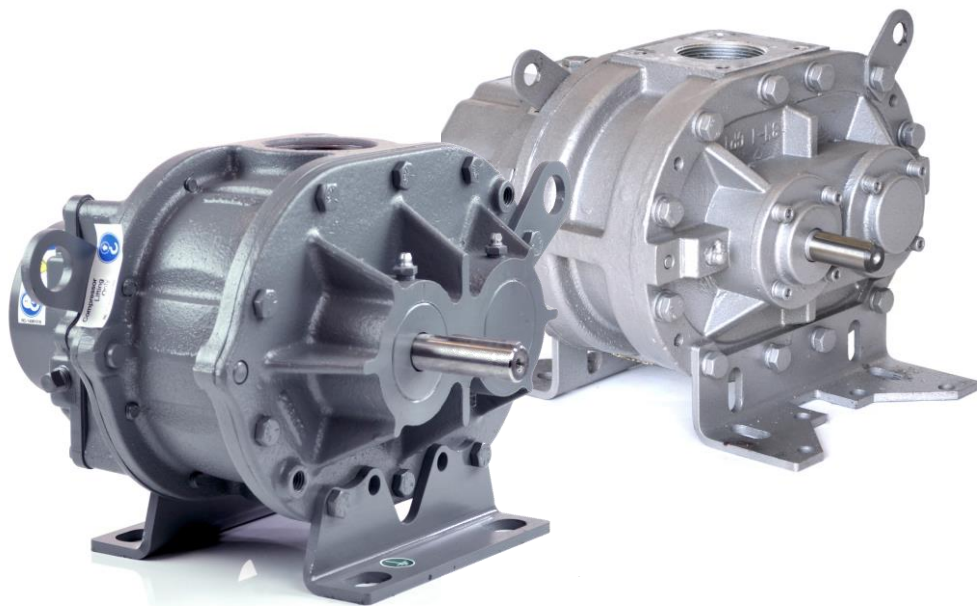

SPECIFICATIONS

	ROOTS 33 URAI	EURUS ZZ3M
Flow Range:	to 195 CFM	to 191 CFM
Max Δ Pressure:	12 psi	12 psi
Max Δ Vacuum:	15" Hg	15" Hg
Maximum RPM:	3600	3600
Minimum RPM:	1090	1078
Max Δ T:	225° F	220° F
Connection:	2" FPT	2" FPT
Shaft Diameter:	3/4"	3/4"
Unit Weight:	74 lb	88 lb

LUBRICATION

Both the 33 URAI and ZZ3M utilize oil lubrication on the gear end and grease on the drive end.

	33 URAI	ZZ3M
Required Oil (Horizontal Unit)	16 oz	11.4 oz
Required Oil (Vertical Unit)	8.5 oz	4 oz
Grease Type	Aluminum Complex NLGI #2	Lithium Complex NLGI #2

Gear End Oil Lubrication

Blowers ship dry from factory and oil must be added before startup. Oil must be an industrial type non-detergent, rust inhibiting, anti-foaming oil of the correct viscosity. See your manual or contact us for assistance selecting the viscosity.

Drive End Grease Lubrication

These manufacturers use different types of grease which should not be mixed. If you plan to change to a different grease than the type that came in your blower, a full purge must be done.

CONFIGURATIONS

Both models feature movable mounting feet that allow the blower to be flipped into four different configurations. The manufacturer's part numbers are listed below.

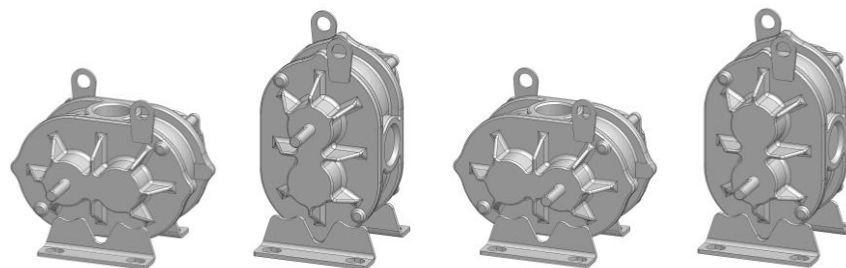

	LEFT HAND	TOP DRIVE	RIGHT DRIVE	BOTTOM DRIVE
33 URAI	6510502L	6510502T	6510502R	6510502B
ZZ3M	ZZ3M	ZZ3M	ZZ3M	ZZ3M

Roots 33 URAI Blower

Dimensional Comparison with Eurus ZZ3M

While these models are typically considered drop-in equivalents, there are minor differences which should be considered for your situation.

SHAFT AND CONNECTIONS

Shaft size and connection size are the most important dimensions to compare. With these two models both measurements are the same.

To determine whether any changes to your piping or enclosure will be needed, take note of the placement of the connections (X,H) and the shaft (P,W).

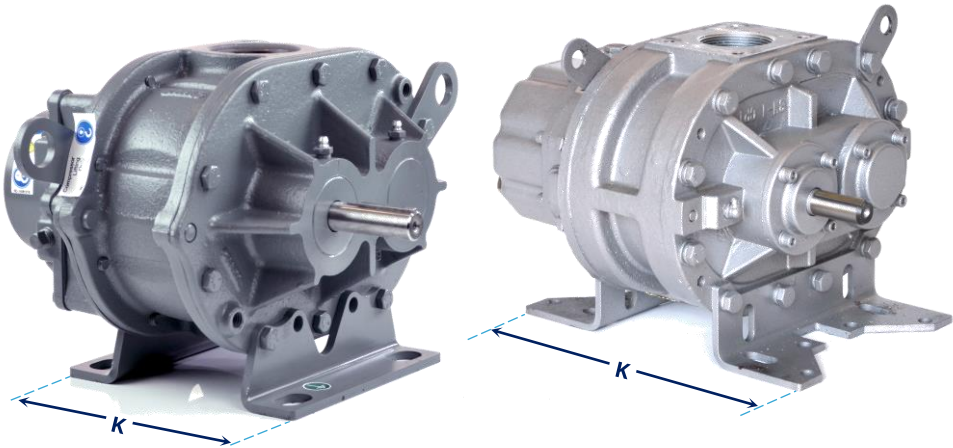
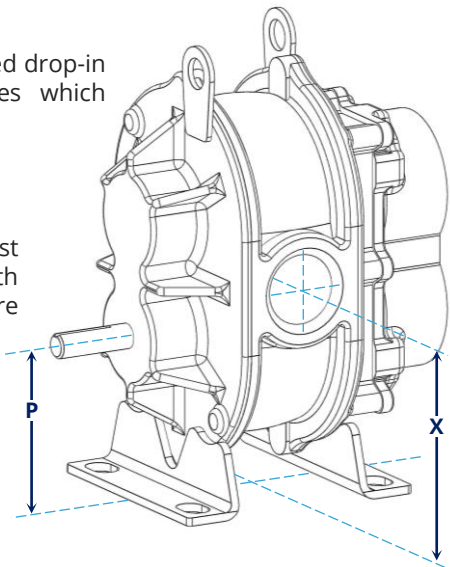

MOUNTING FEET

Both the 33 URAI and ZZ3M have oval mounting slots in the feet with similar center points. If switching to a ZZ3M, check dimension K as the feet extend further out and could conflict with other items in a blower package such as drive guards. These feet can be modified if necessary to reduce the length.

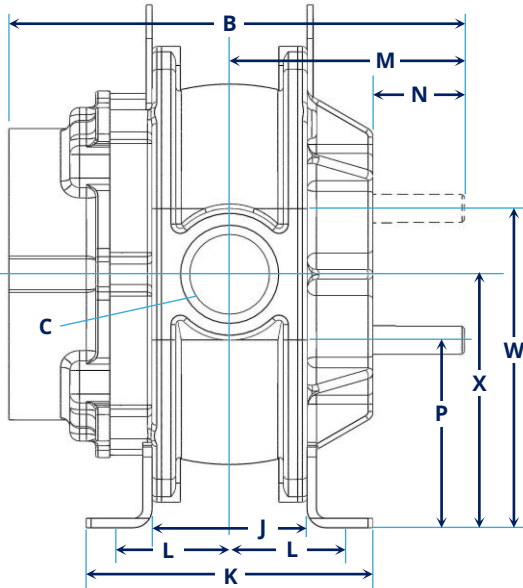
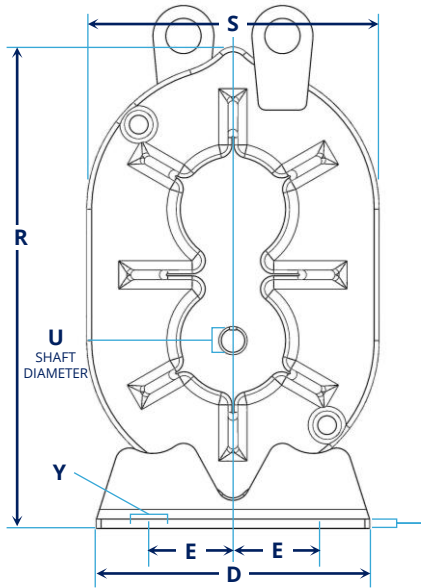
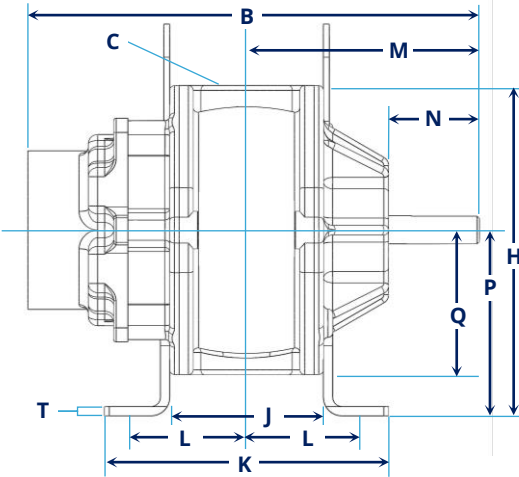
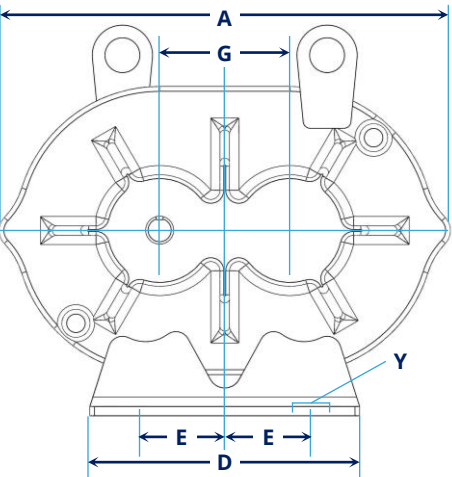

MAKE	MODEL	A	B	C	D	E	G	H	J	K	L	M	N	P	Q	R	S	T	U	W	X	Y
Roots	33 URAI	12.13	12.13	2" NPT	7.25	2.5 - 2.88	3.5	8.88	4.13	7.63	3 - 3.25	6.25	2.44	5	3.88	12.81	7.75	0.25	0.75	8.5	6.75	0.44 bolts
Eurus	ZZ3M	11.3	12.81	2" NPT	7.87	2.87	3.54	8.96		10.91	2.97 - 3.53	6.24	1.95	4.49	3.96	11.91	7.91		0.75	8.03	6.26	0.55x1.10

All measurements shown in inches

Roots 33 URAI

PRESSURE PERFORMANCE

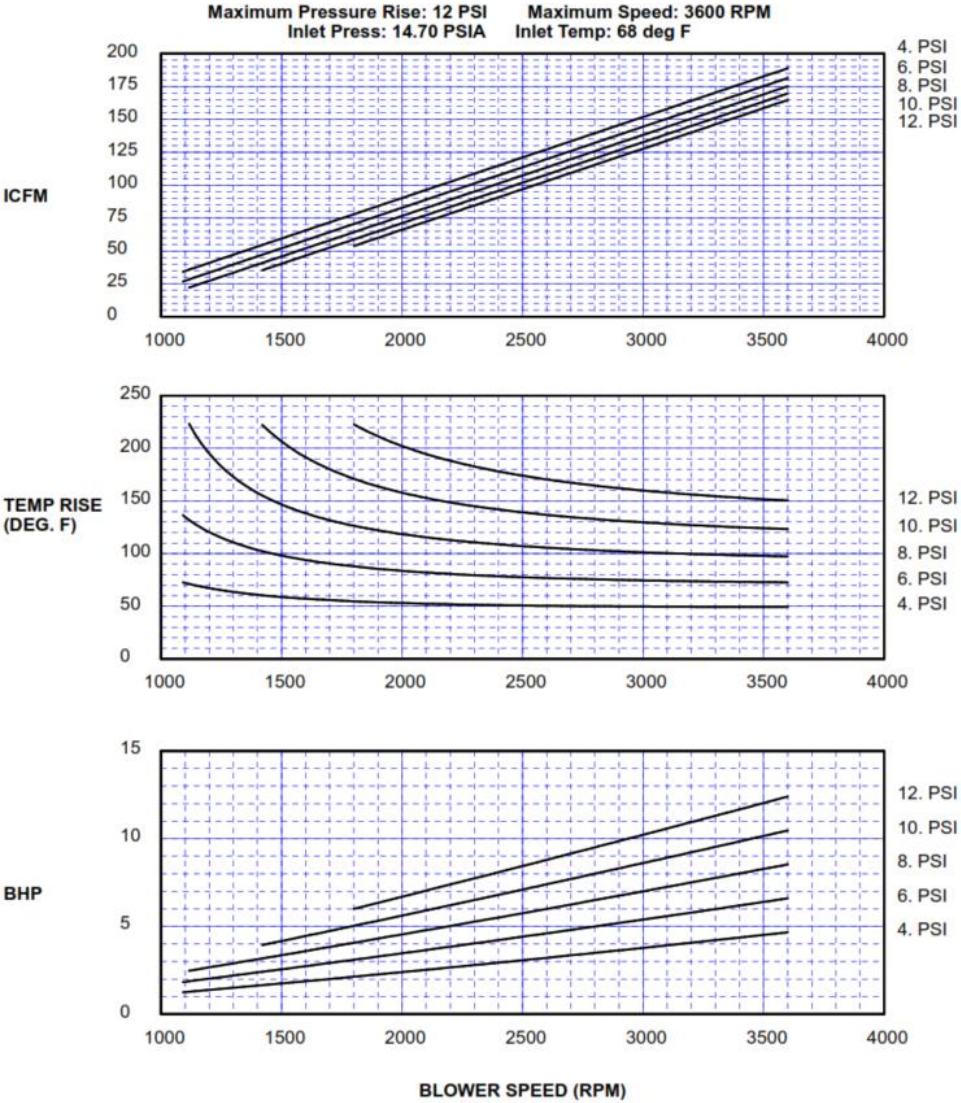

Eurus ZZ3M

PRESSURE PERFORMANCE

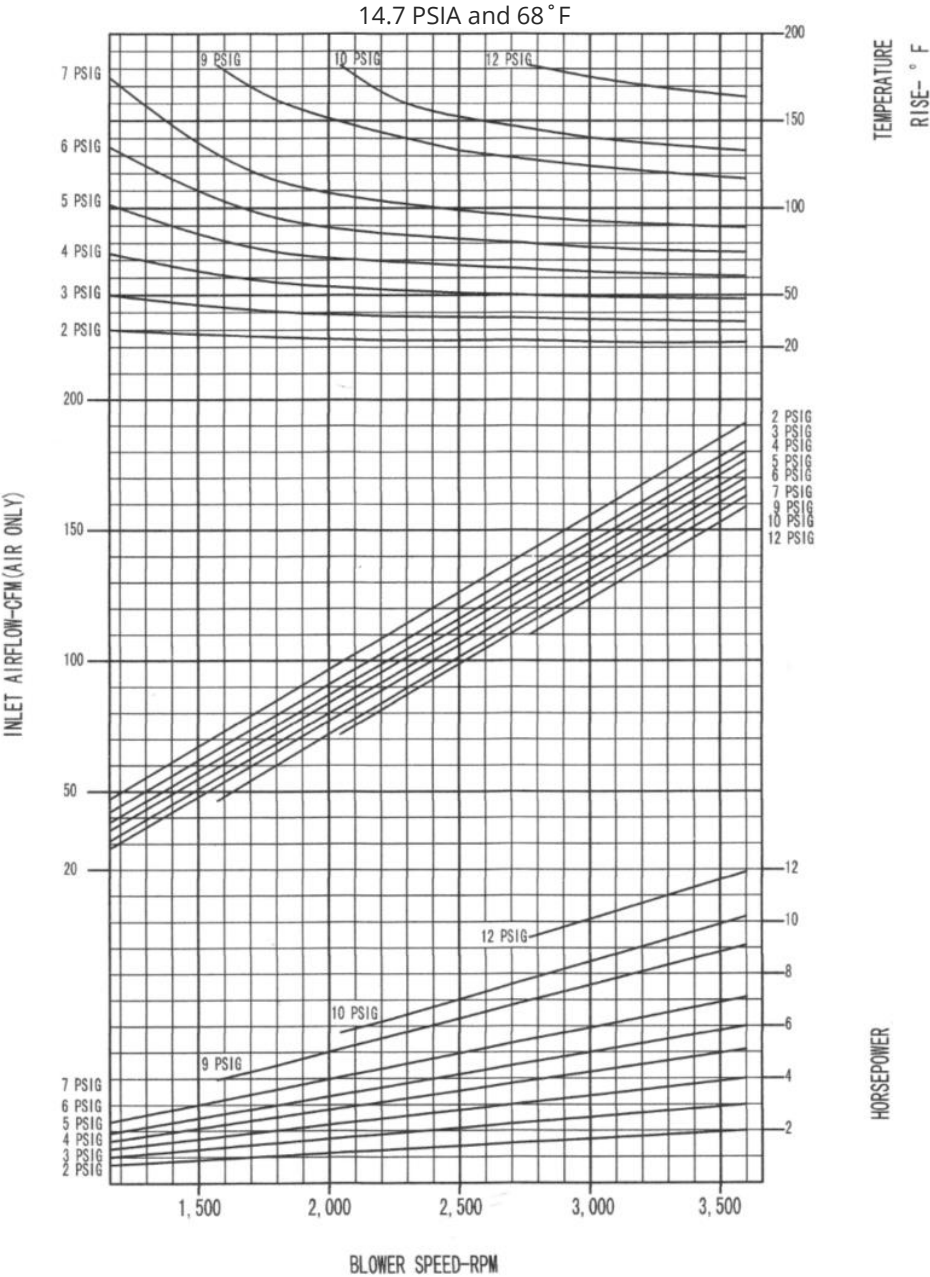

Roots 33 URAI

VACUUM PERFORMANCE

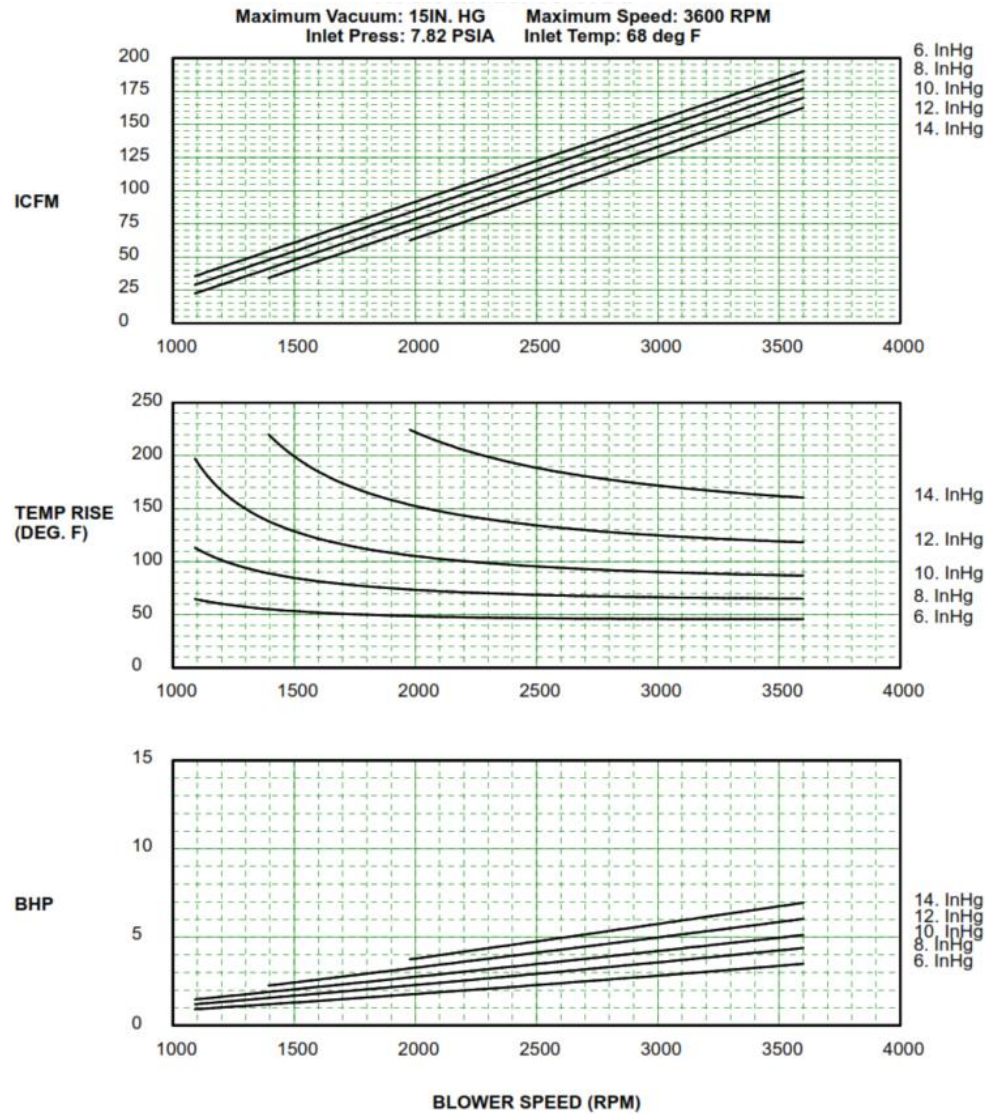

Eurus ZZ3M

VACUUM PERFORMANCE

