

# Roots 56 URAI Blower

## Comparison with Eurus ZZ5M

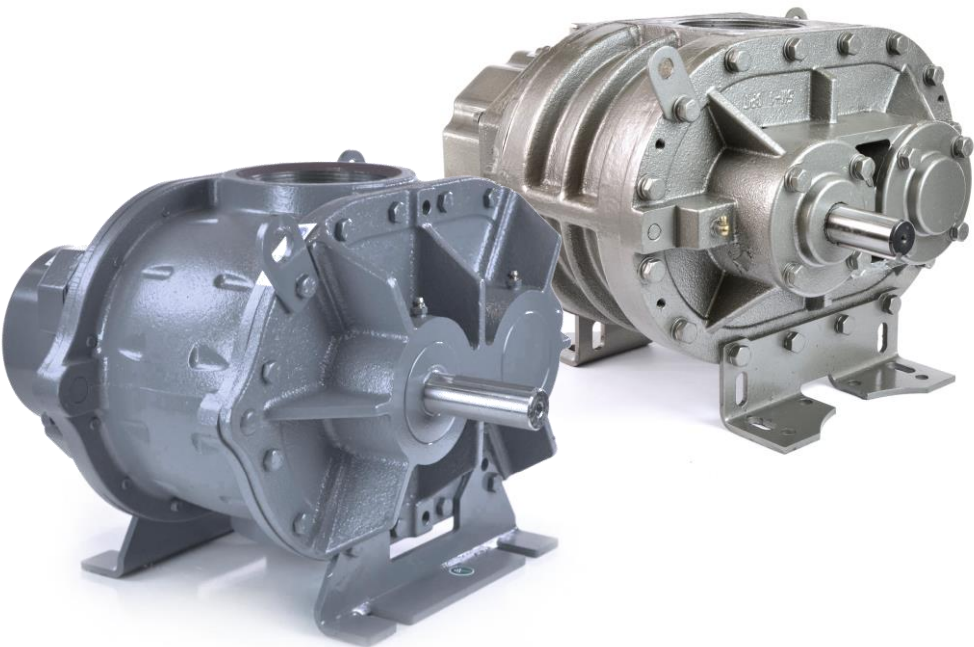

Both the 56 URAI and ZZ5M utilize oil lubrication on the gear end and grease on the drive end.

	56 URAI	ZZ5M
Required Oil (Horizontal Unit)	27.6 oz	36.41 oz
Required Oil (Vertical Unit)	16 oz	14.83 oz
Grease Type	Aluminum Complex NLGI #2	Lithium Complex NLGI #2

### Gear End Oil Lubrication

Blowers ship dry from factory and oil must be added before startup. Oil must be an industrial type non-detergent, rust inhibiting, anti-foaming oil of the correct viscosity. See your manual or contact us for assistance selecting the viscosity.

### Drive End Grease Lubrication

These manufacturers use different types of grease which should not be mixed. If you plan to change to a different grease than the type that came in your blower, a full purge must be done.

## SPECIFICATIONS

	ROOTS 56 URAI	EURUS ZZ5M
Flow Range:	to 580 CFM	to 544 CFM
Max Δ Pressure:	13 psi	13 psi
Max Δ Vacuum:	15" Hg	16" Hg
Maximum RPM:	2850	2850
Minimum RPM:	763	751
Max ΔT:	225° F	220° F
Connection:	4" FPT	4" FPT
Shaft Diameter:	1 1/8"	1 1/8"
Unit Weight:	170 lb	217 lb

## CONFIGURATIONS

Both models feature movable mounting feet that allow the blower to be flipped into four different configurations. The manufacturer's part numbers are listed below.

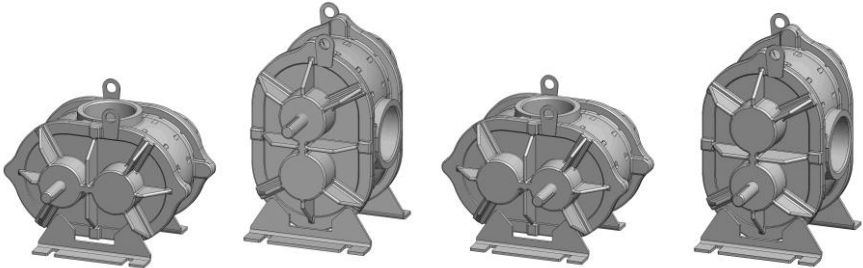

	LEFT HAND	TOP DRIVE	RIGHT DRIVE	BOTTOM DRIVE
56 URAI	6511302L	6511302T	6511302R	6511302B
ZZ5M	ZZ5MA	ZZ5MA	ZZ5MA	ZZ5MA

# Roots 56 URAI Blower

## Dimensional Comparison with Eurus ZZ5M

While these models are considered drop-in equivalents, there are minor differences which should be considered for your situation.

### SHAFT AND CONNECTIONS

Shaft size and connection size are the most important dimensions to compare. With these two models both measurements are the same.

To determine whether any changes to your piping or enclosure will be needed, take note of the placement of the connections (X,H) and the shaft (P,W).

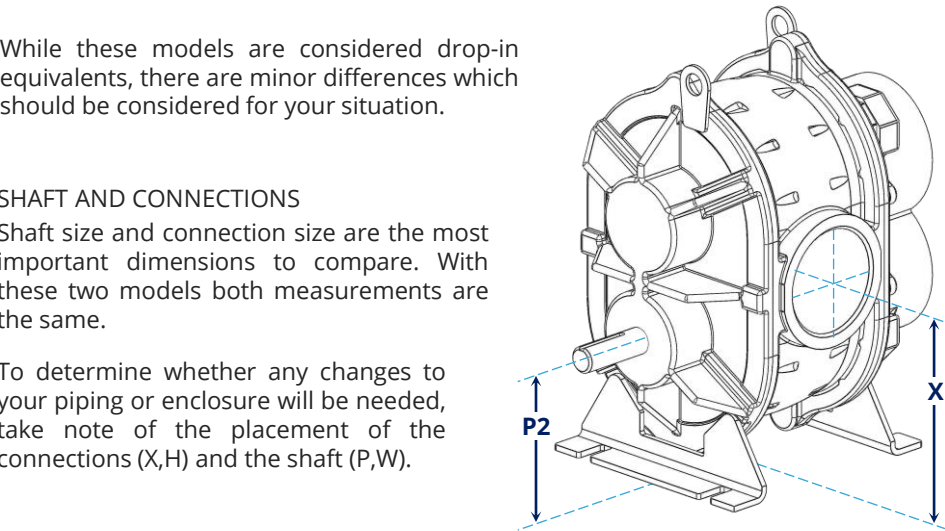

### MOUNTING FEET

The Eurus ZZ5M has an oval mounting slot, while the Roots 56 URAI has an open-end mounting slot. Both units feature universal mounting feet that can be moved to accommodate changes in configuration.

If switching to a ZZ5L, check dimension K as the feet extend further out and could conflict with other items in a blower package such as drive guards.

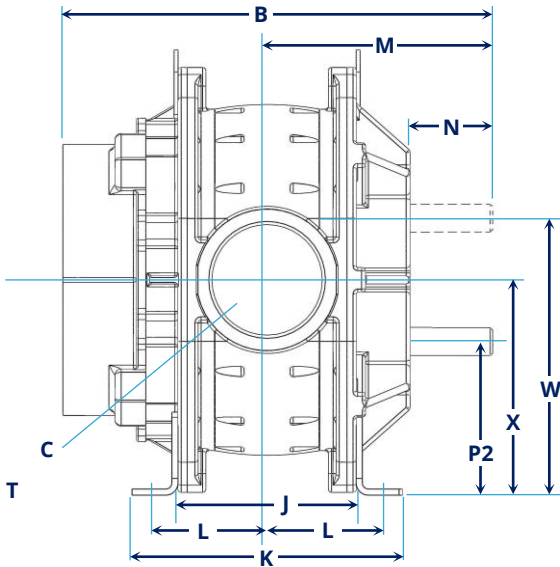
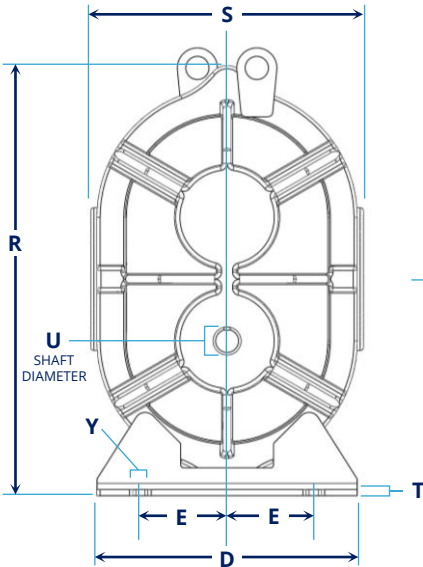
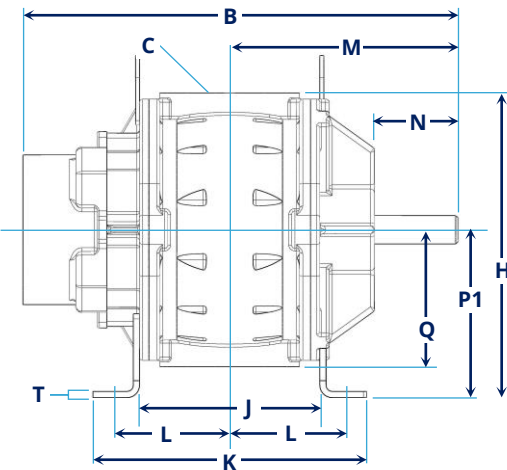
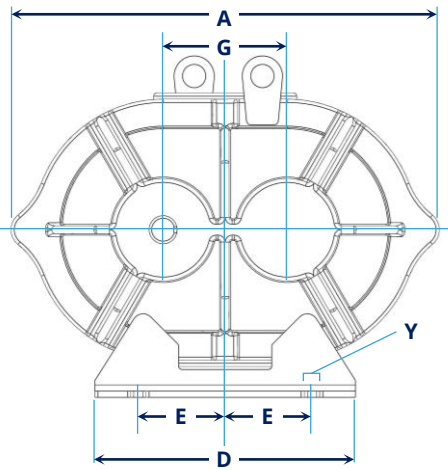
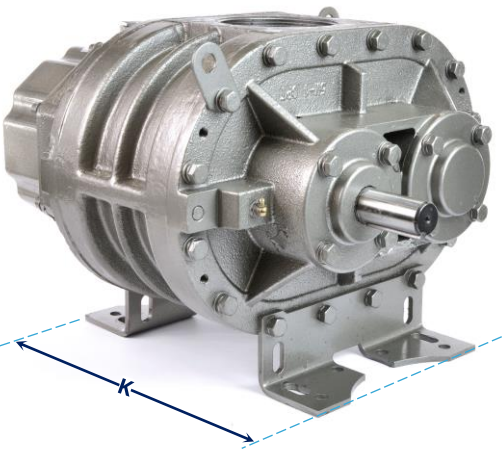

MAKE	MODEL	A	B	C	D	E	G	H	J	K	L	M	N	P1	P2	Q	R	S	T	U	W	X	Y
Roots	56 URAI	17.25	17.5	4" NPT	10.5	3.5	5	12.25	7.24	11	4.25 - 5	9.19	3.38	6.75	6.25	5.5	17.38	11	0.25	1.125	11.25	8.75	0.5" bolts
Eurus	ZZ5MA	15.47	18.76	4" NPT	8.66	3.5	5.08	12.17	6.89	12.48	4.27 - 4.83	9.19	2.5	6.97	5.47	5.2	15.75	10.39	0.24	1.125	15.75	8.01	0.55 x 1.1

All measurements shown in inches

# Roots 56 URAI

## PRESSURE PERFORMANCE

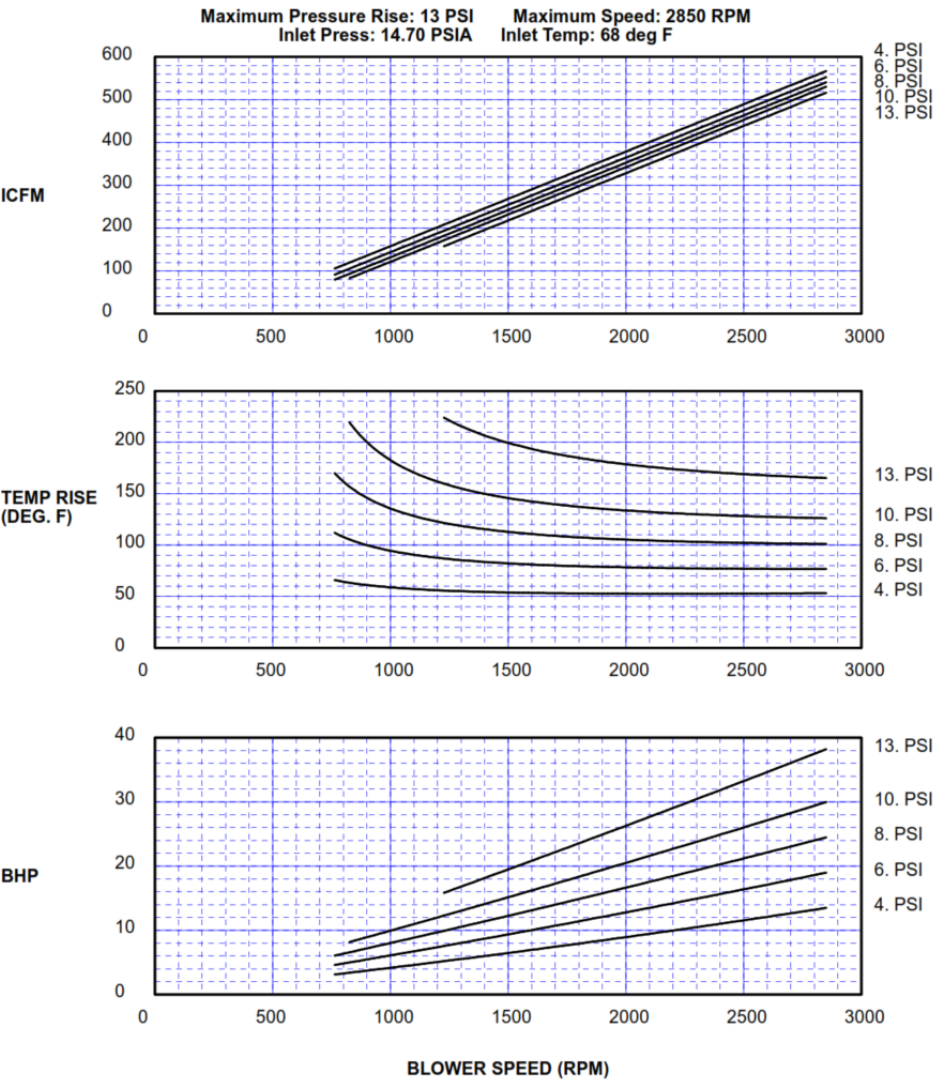

# Eurus ZZ5M

## PRESSURE PERFORMANCE

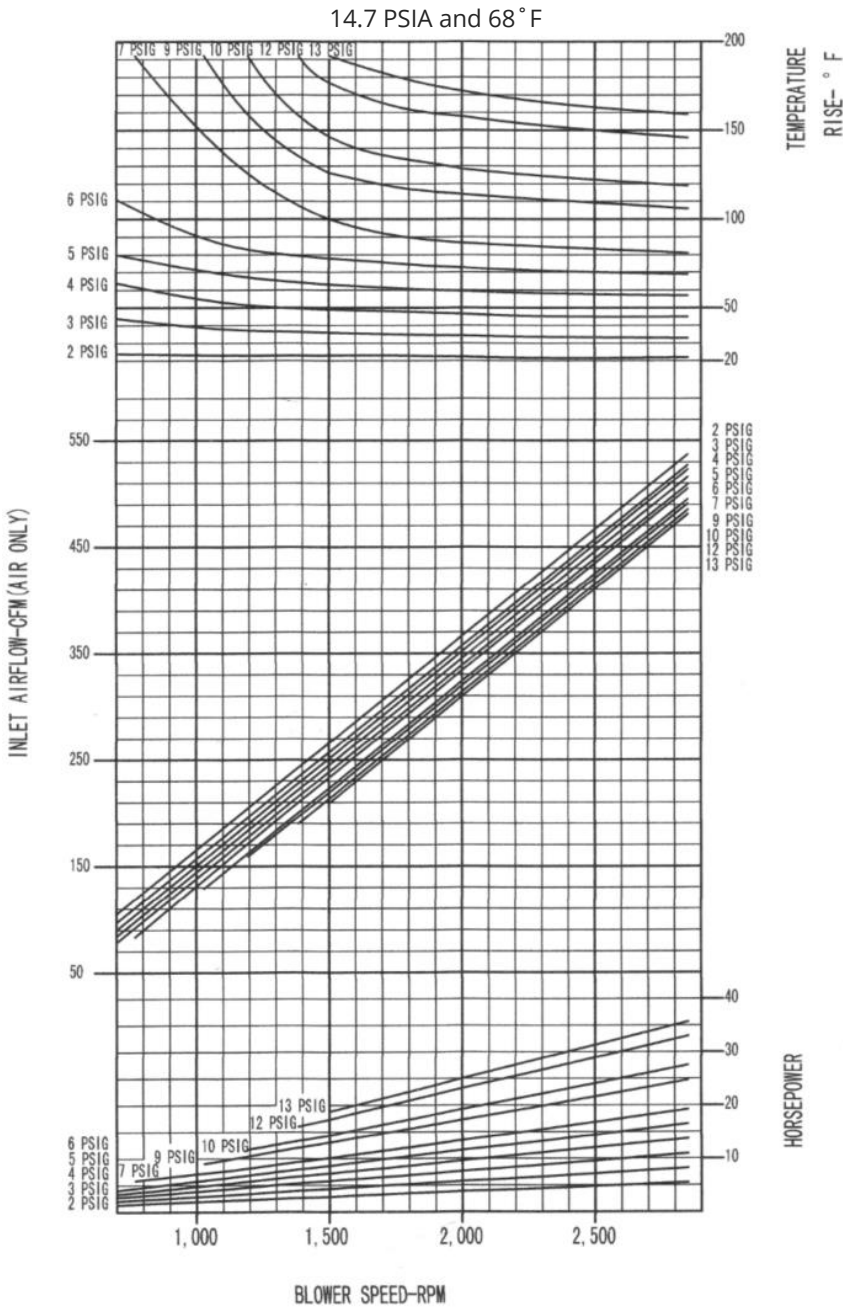

# Roots 56 URAI

VACUUM PERFORMANCE

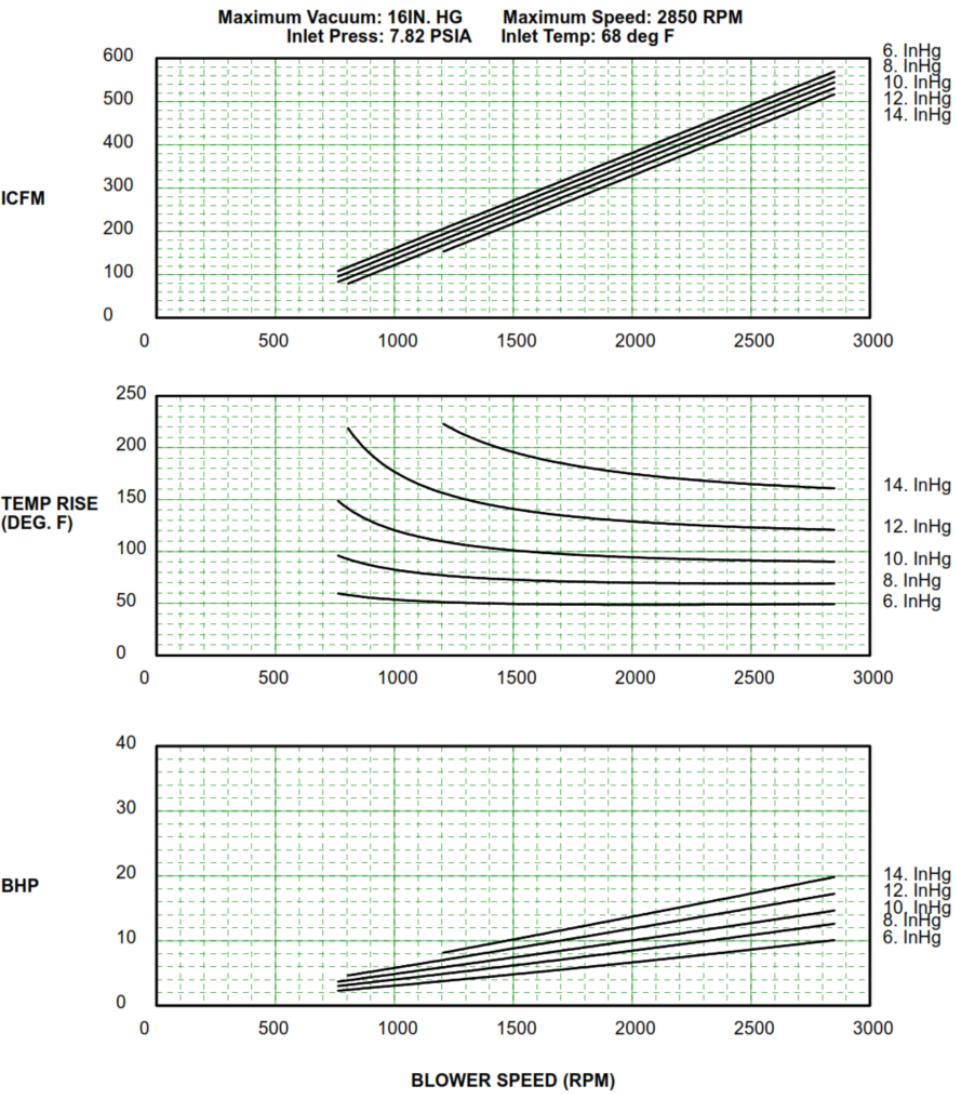

# Eurus ZZ5M

VACUUM PERFORMANCE

