

Roots 56 URAI Blower

Comparison with Sutorbilt Legend 5M

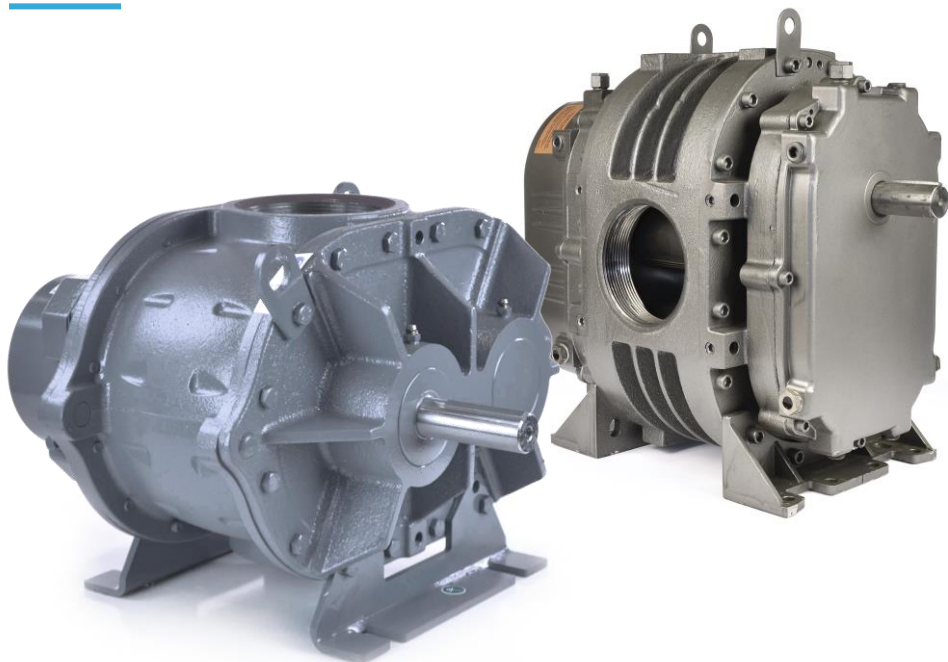

Both the 56 URAI and 5M Legend utilize oil lubrication on the gear end and grease on the drive end.

	56 URAI	5M LEGEND
Required Oil (Horizontal Unit)	27.6 oz	40 oz
Required Oil (Vertical Unit)	16 oz	18 oz
Grease Type	Aluminum Complex NLGI #2	Lithium Complex NLGI #2

Gear End Oil Lubrication

Blowers ship dry from factory and oil must be added before startup. Oil must be an industrial type non-detergent, rust inhibiting, anti-foaming oil of the correct viscosity. See your manual or contact us for assistance selecting the viscosity.

Drive End Grease Lubrication

These manufacturers use different types of grease which should not be mixed. If you plan to change to a different grease than the type that came in your blower, a full purge must be done.

SPECIFICATIONS

	ROOTS 56 URAI	SUTORBILT 5M LEGEND
Flow Range:	to 580 CFM	to 542 CFM
Max Δ Pressure:	13 psi	13 psi
Max Δ Vacuum:	15" Hg	16" Hg
Maximum RPM:	2850	2850
Minimum RPM:	763	764
Max Δ T:	225° F	180° F
Connection:	4" FPT	4" FPT
Shaft Diameter:	1 1/8"	1 1/8"
Unit Weight:	170 lb	232 lb

CONFIGURATIONS

Both models feature movable mounting feet that allow the blower to be flipped into four different configurations. The manufacturer's part numbers are listed below.

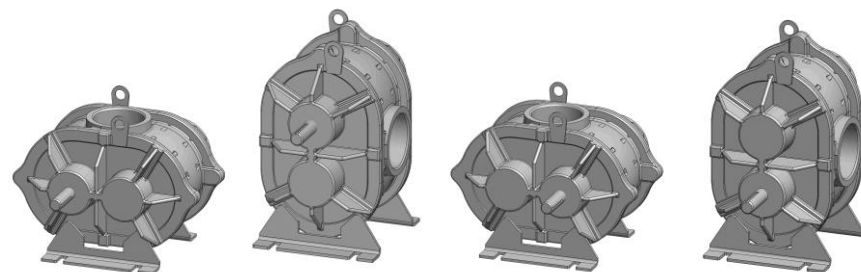

	LEFT HAND	TOP DRIVE	RIGHT DRIVE	BOTTOM DRIVE
56	6511302L	6511302T	6511302R	6511302B
5M	GAEMC*A	GAEMA*A	GAEMD*A	GAEMB*A

**The sixth character in the Sutorbilt part number indicates the series designation. As of this print, the current series is S. Previous series include R, P and L.*

Roots 56 URAI Blower

Dimensional Comparison with Sutorbilt 5M

While these models are considered drop-in equivalents, there are minor differences which should be considered for your situation.

SHAFT AND CONNECTIONS

Shaft size and connection size are the most important dimensions to compare. With these two models both measurements are the same.

To determine whether any changes to your piping or enclosure will be needed, take note of the placement of the connections (X,H) and the shaft (P,W).

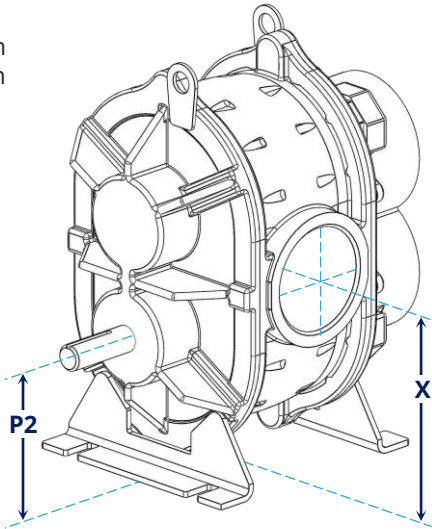

MOUNTING FEET

The Sutorbilt 5M has an oval mounting hole, while the Roots 56 URAI has an open-end mounting slot. Both units feature universal mounting feet that can be moved to accommodate changes in configuration.

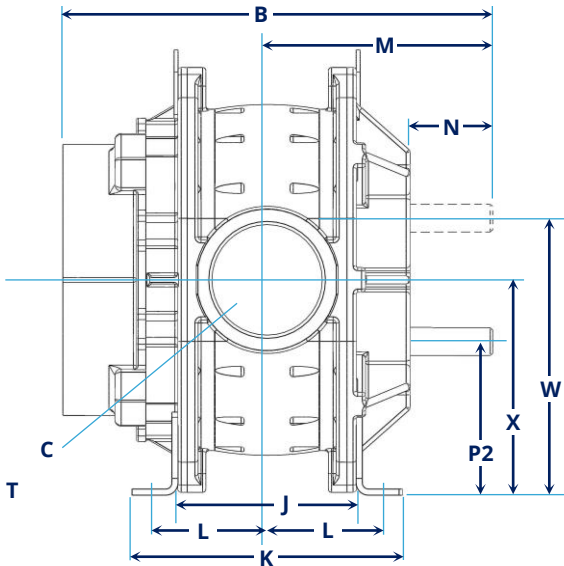
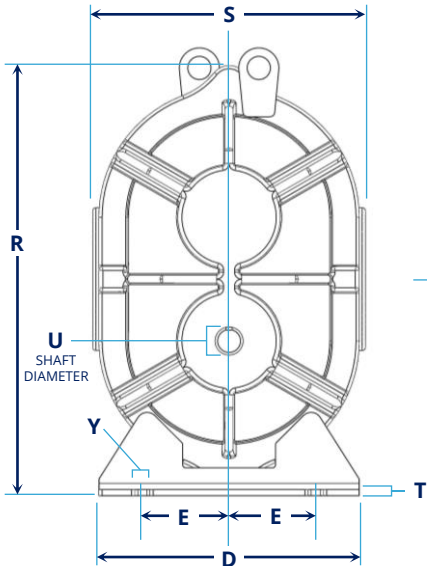
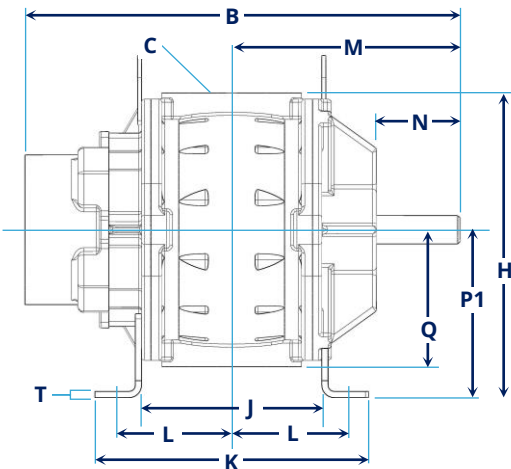
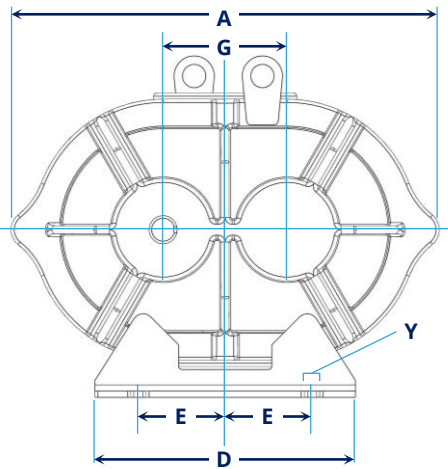
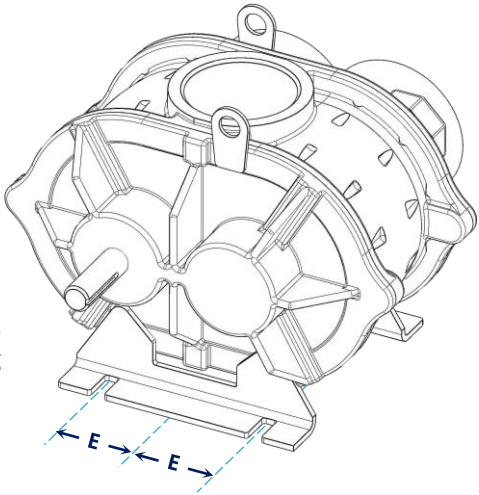

MAKE	MODEL	A	B	C	D	E	G	H	J	K	L	M	N	P1	P2	Q	R	S	T	U	W	X	Y
Roots	56 URAI	17.25	17.5	4" NPT	10.5	3.5	5	12.25	7.24	11	4.25 - 5	9.19	3.38	6.75	6.25	5.5	17.38	11	0.25	1.125	11.25	8.75	0.5" bolts
Sutorbilt	5M Legend	15.38	18.38	4" NPT	9	3.5	5	12.19	6.86	10.5	4.13 - 4.88	9.19	2.5	7	5.5	5.19	15.85	10.38	0.38	1.125	10.5	8	0.56 x 0.75

All measurements shown in inches

Roots 56 URAI

PRESSURE PERFORMANCE

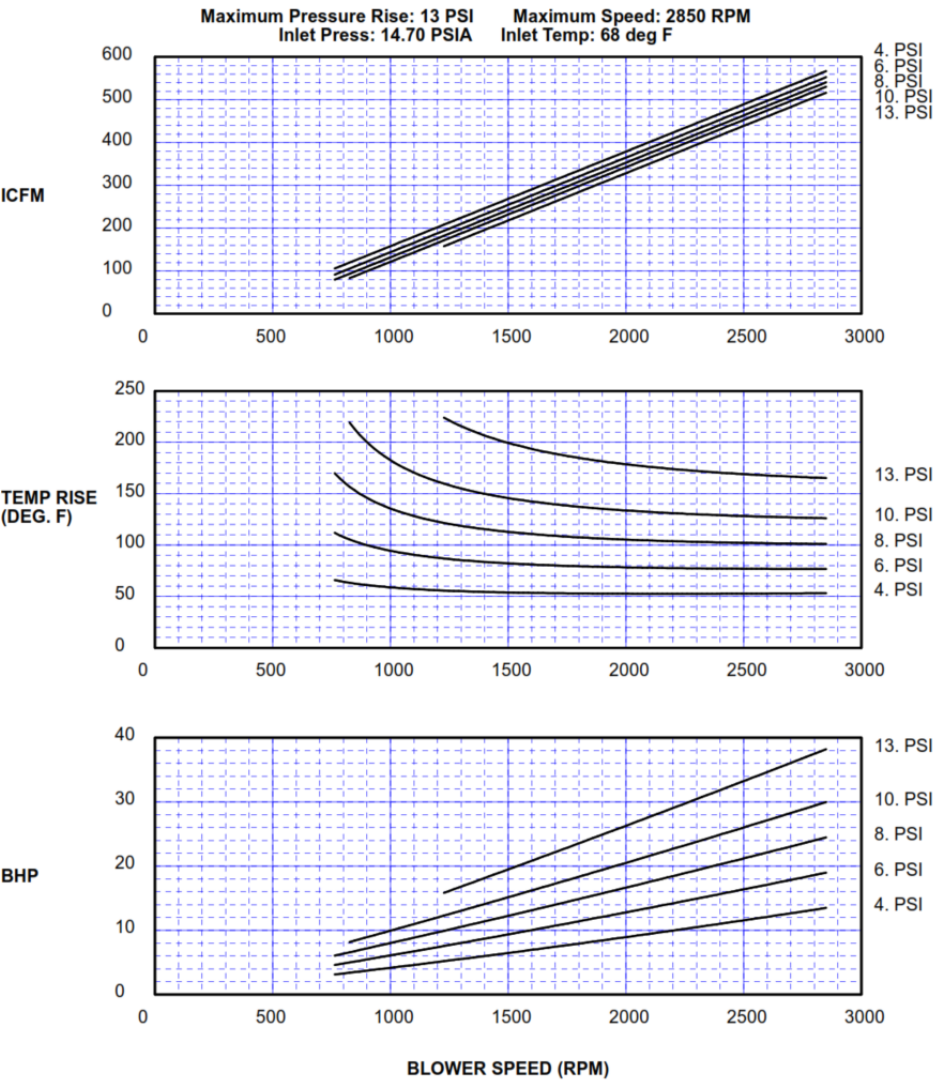

Sutorbilt 5M Legend

PRESSURE PERFORMANCE

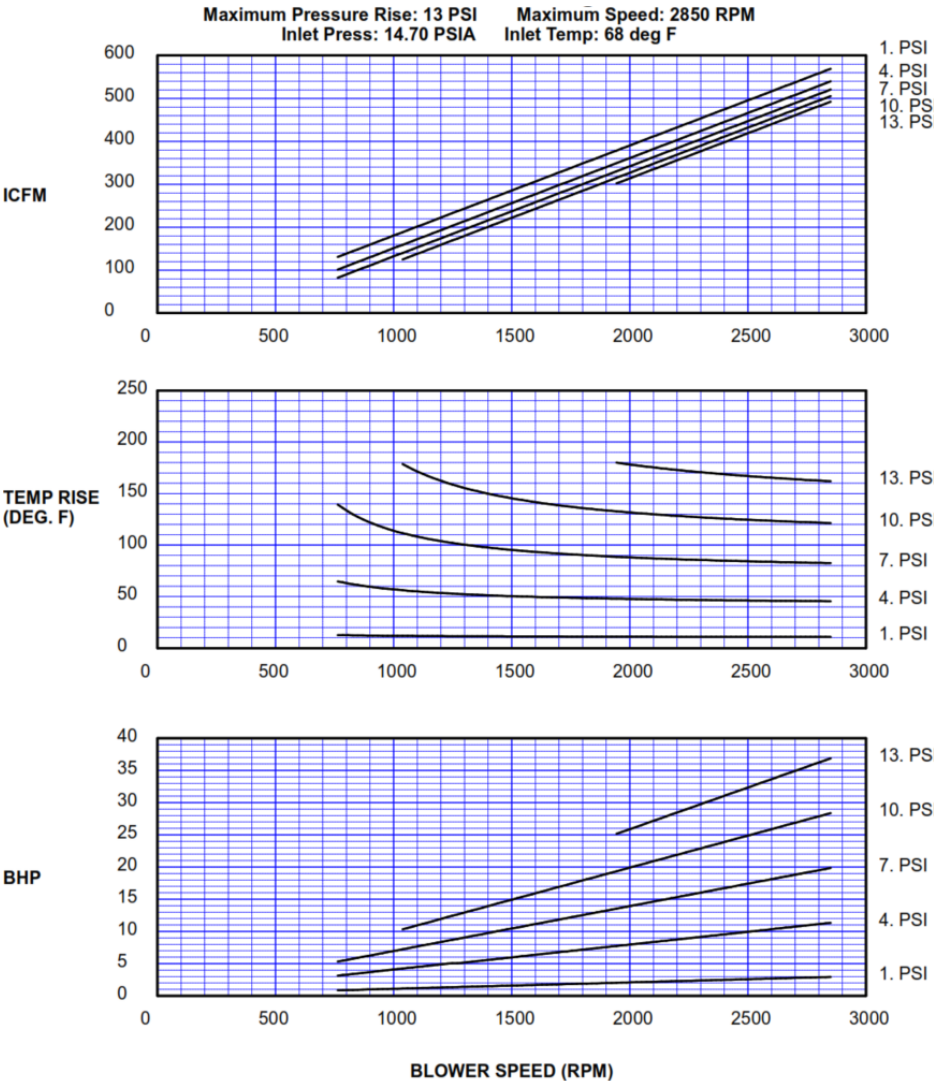

Roots 56 URAI

VACUUM PERFORMANCE

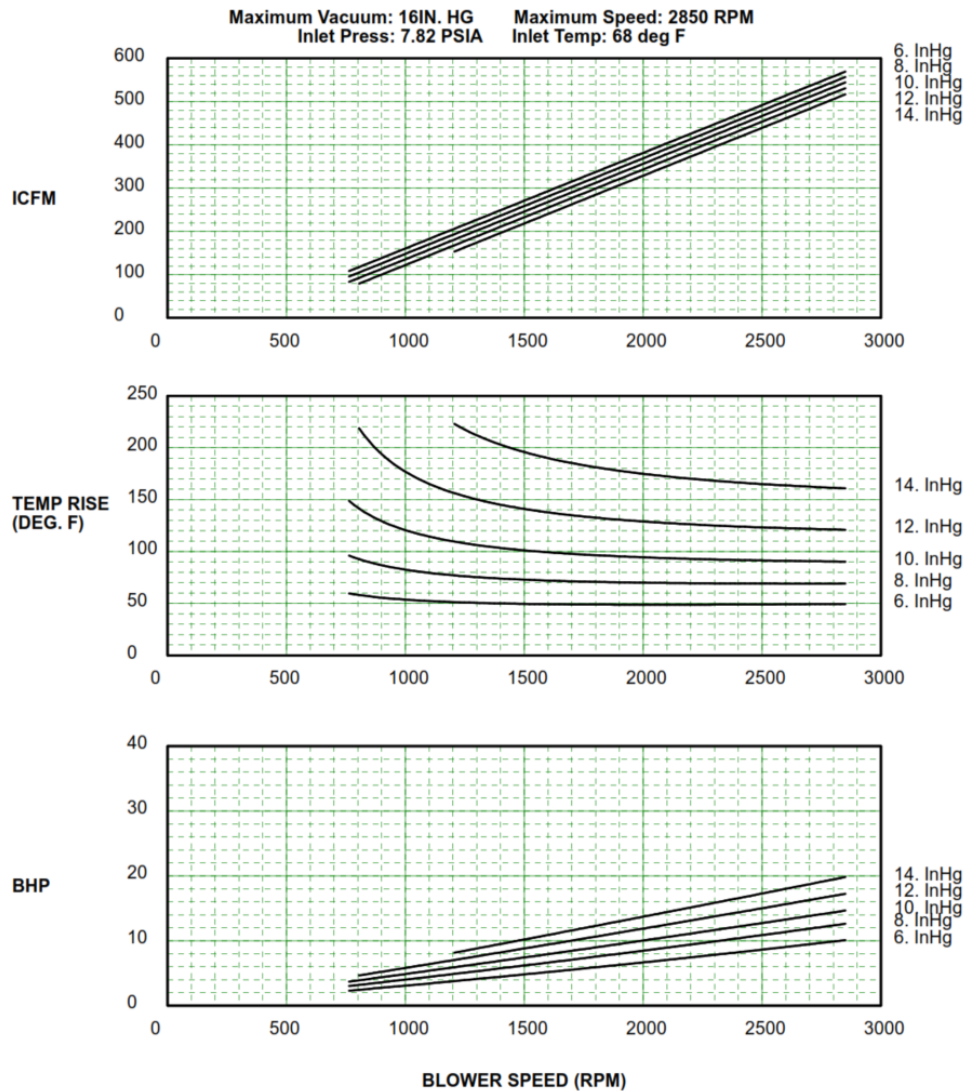

Sutorbilt 5M Legend

VACUUM PERFORMANCE

