

Roots 59 URAI Blower

Comparison with Eurus ZZ5L



SPECIFICATIONS

	ROOTS 59 URAI	EURUS ZZ5L
Flow Range:	to 857 CFM	to 862 CFM
Max Δ Pressure:	7 psi	7 psi
Max Δ Vacuum:	15" Hg	14" Hg
Maximum RPM:	2850	2850
Minimum RPM:	763	751
Max ΔT:	225° F	170° F
Connection:	4" FPT	4" FPT
Shaft Diameter:	1 1/8"	1 1/8"
Unit Weight:	204 lb	285 lb

LUBRICATION

Both the 59 URAI and ZZ5L utilize oil lubrication on the gear end and grease on the drive end.

	59 URAI	ZZ5L
Required Oil (Horizontal Unit)	27.6 oz	36.41 oz
Required Oil (Vertical Unit)	16 oz	14.83 oz
Grease Type	Aluminum Complex NLGI #2	Lithium Complex NLGI #2

Gear End Oil Lubrication

Blowers ship dry from factory and oil must be added before startup. Oil must be an industrial type non-detergent, rust inhibiting, anti-foaming oil of the correct viscosity. See your manual or contact us for assistance selecting the viscosity.

Drive End Grease Lubrication

These manufacturers use different types of grease which should not be mixed. If you plan to change to a different grease than the type that came in your blower, a full purge must be done.

CONFIGURATIONS

Both models feature movable mounting feet that allow the blower to be flipped into four different configurations. The manufacturer's part numbers are listed below.

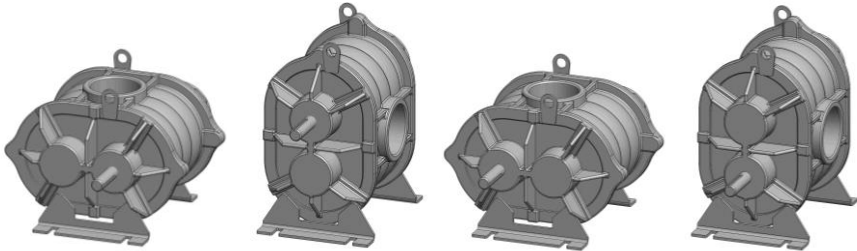

	LEFT HAND	TOP DRIVE	RIGHT DRIVE	BOTTOM DRIVE
59 URAI	6511402L	6511402T	6511402R	6511402B
ZZ5L	ZZ5LA	ZZ5LA	ZZ5LA	ZZ5LA

Roots 59 URAI Blower

Dimensional Comparison with Eurus ZZ5L

While these models are considered drop-in equivalents, there are minor differences which should be considered for your situation.

SHAFT AND CONNECTIONS

Shaft size and connection size are the most important dimensions to compare. With these two models both measurements are the same.

To determine whether any changes to your piping or enclosure will be needed, take note of the placement of the connections (X,H) and the shaft (P,W).

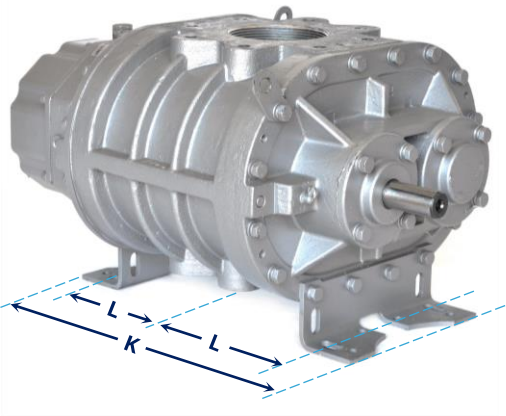
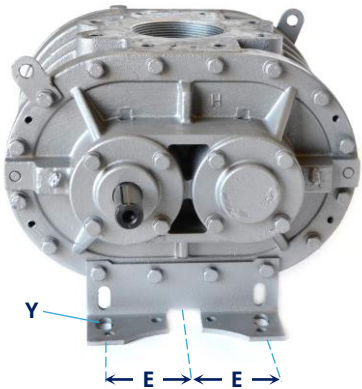
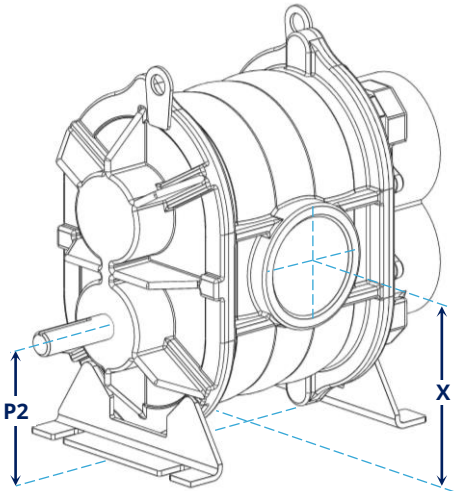

MOUNTING FEET

The ZZ5L has an oval mounting slot (pictured above), while the 59 URAI has an open-end mounting slot (pictured left). If switching to a ZZ5L check dimension K as the feet extend further out and could conflict with other items in a blower package such as drive guards.

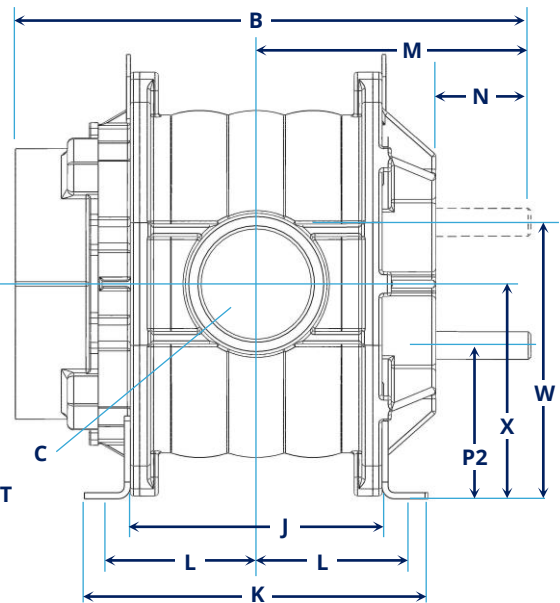
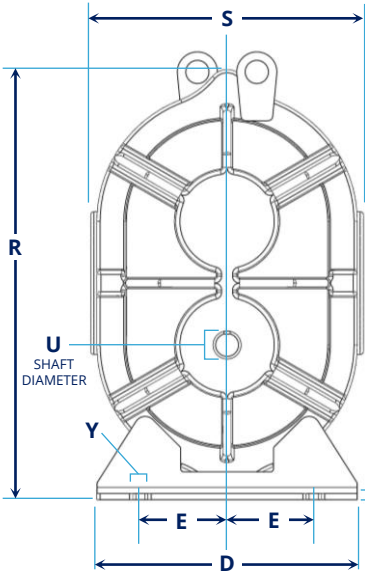
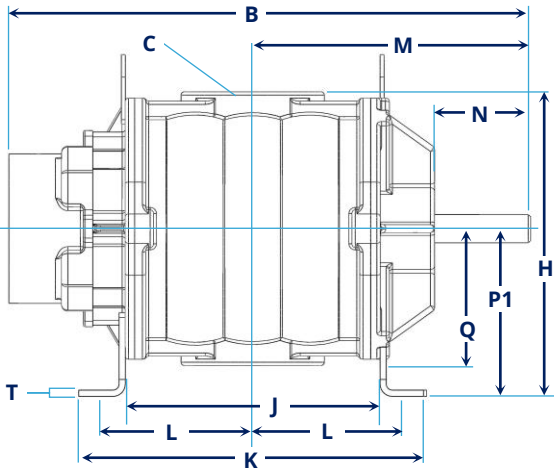
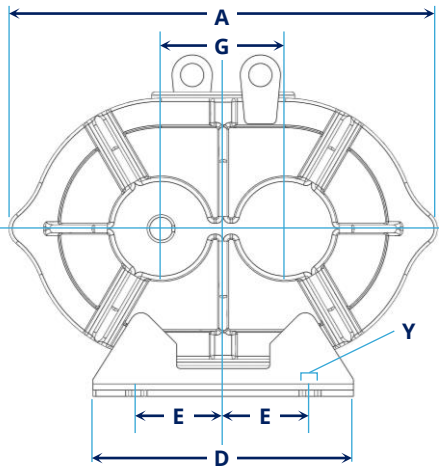

MAKE	MODEL	A	B	C	D	E	G	H	J	K	L	M	N	P1	P2	Q	R	S	T	U	W	X	Y
Roots	59 URAI	17.25	21	4" NPT	10.5	3.5	5	12.25	10.24	14	6.0 - 6.5	11.19	3.88	6.75	6.25	5.5	17.38	11	0.25	1.125	11.25	8.75	0.5 x 1.63
Eurus	ZZ5LA	15.47	22.81	4" NPT	8.66	3.5	5.08	12.17	10.94	16.54	6.3 - 6.85	11.22	2.5	6.97	5.47	5.2	15.75	10.39	0.24	1.125	10.55	8.01	0.55 x 1.1

All measurements shown in inches

Roots 59 URAI

PRESSURE PERFORMANCE

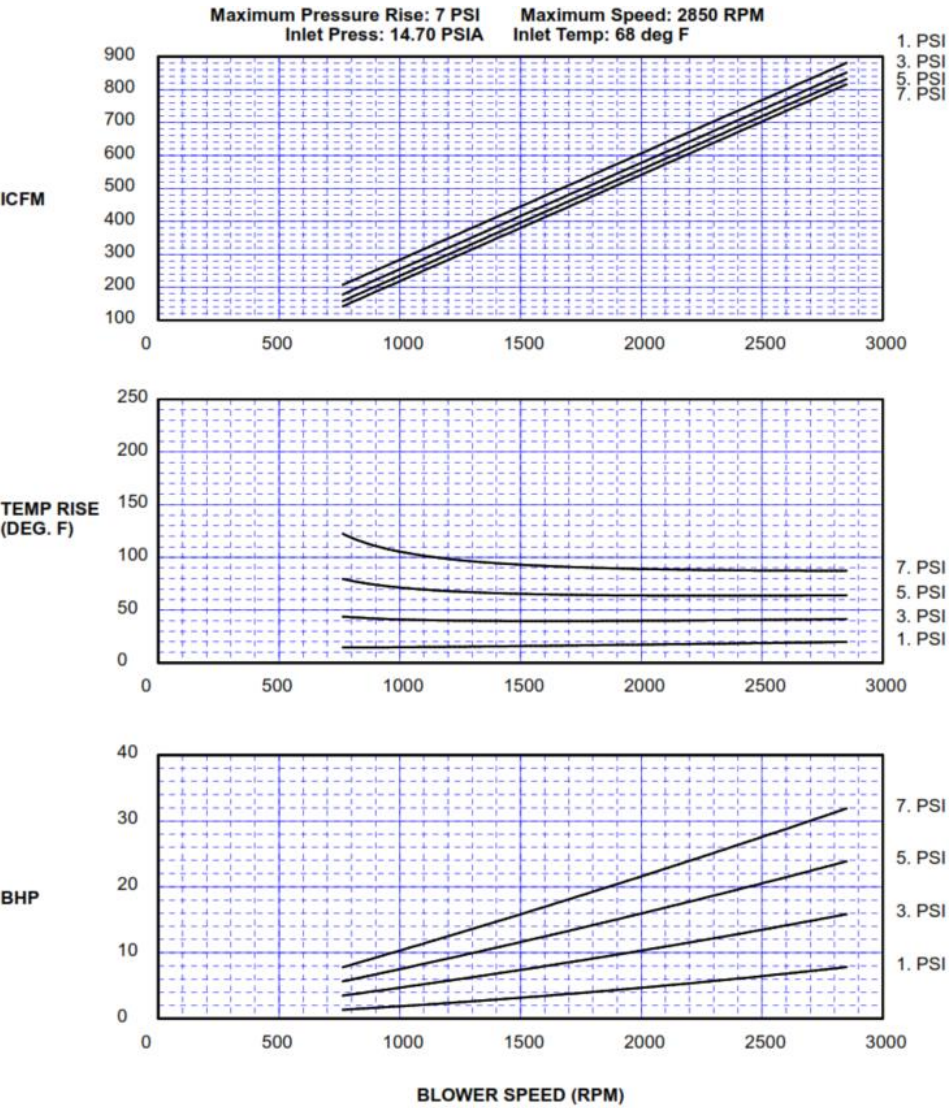

Eurus ZZ5L

PRESSURE PERFORMANCE

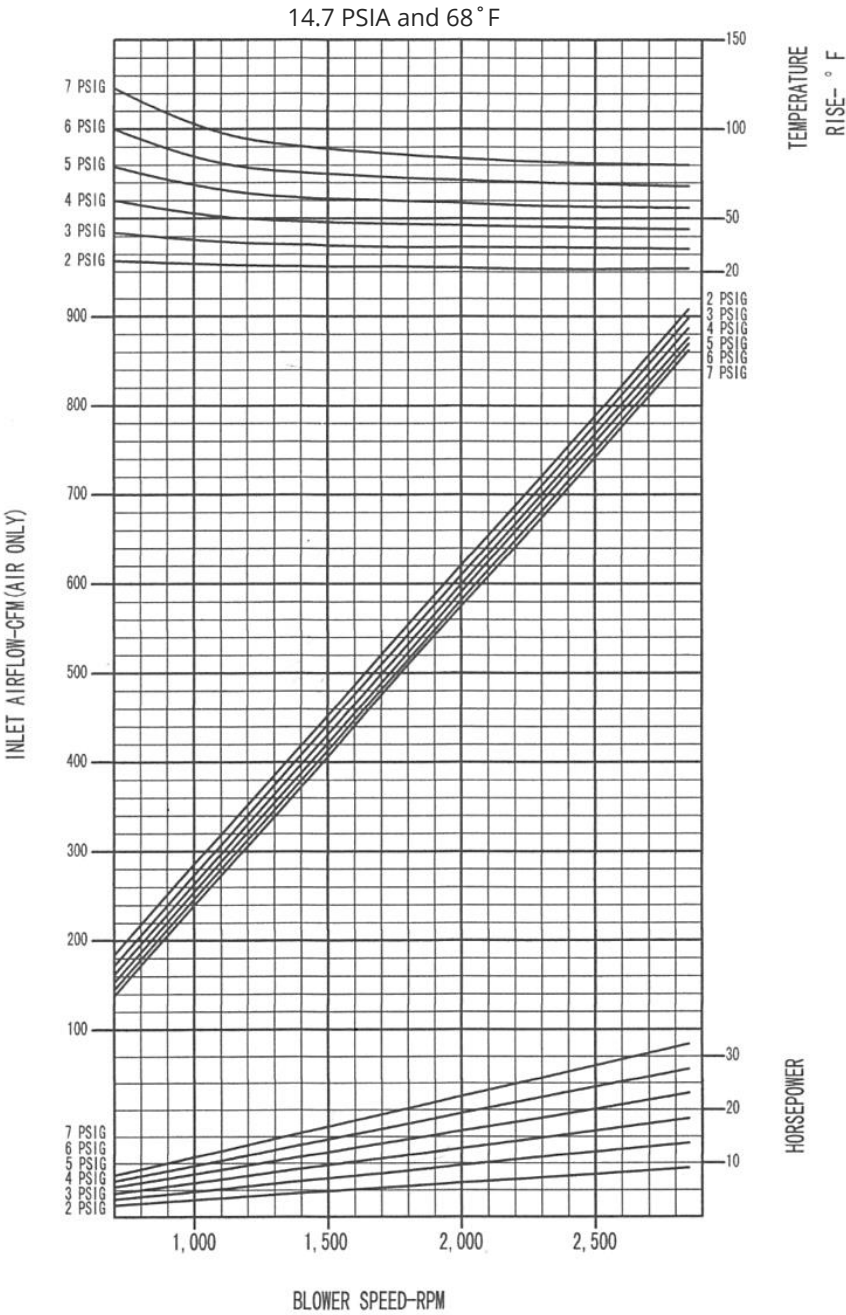

Roots 59 URAI

VACUUM PERFORMANCE

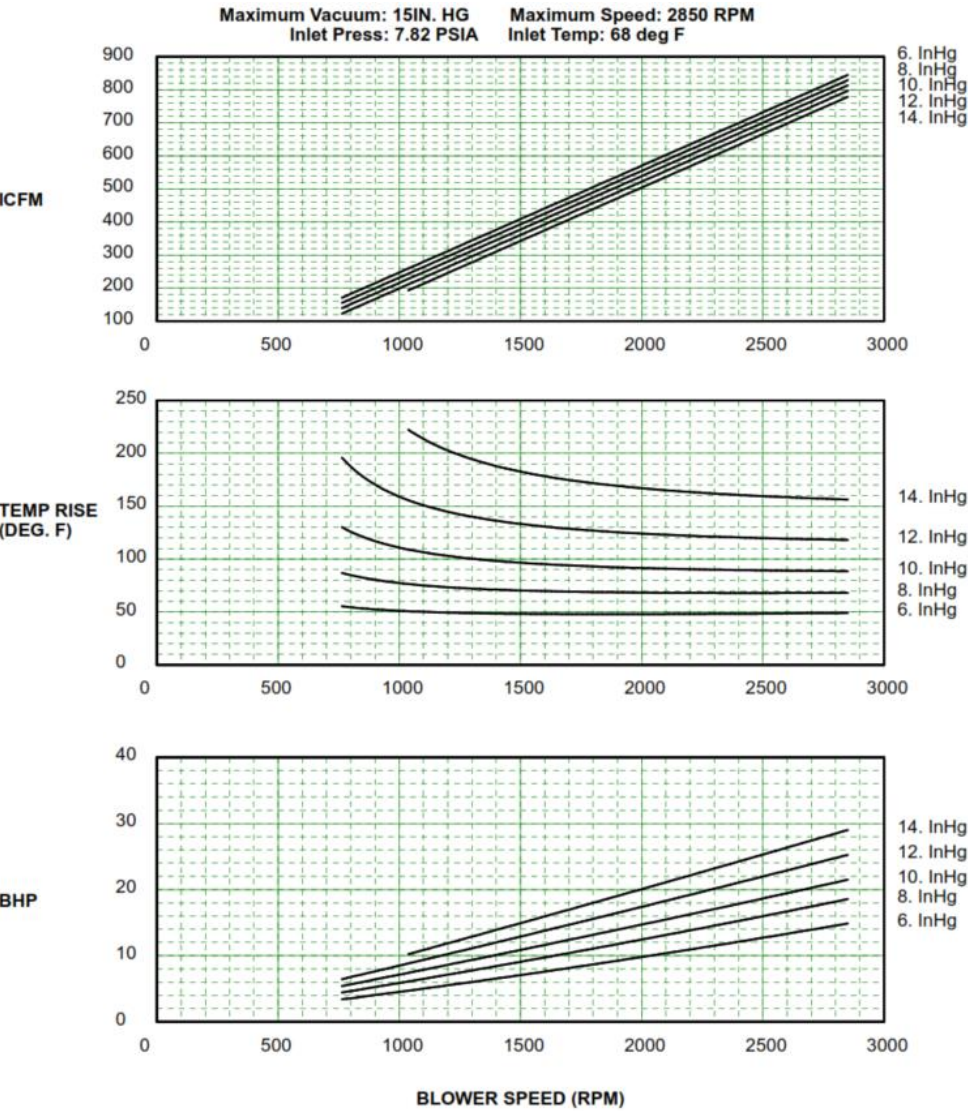

Eurus ZZ5L

VACUUM PERFORMANCE

