

Roots 68 URAI Blower

Comparison with Tuthill 6008 Dual Lobe Blower

The 6008 model is in the Tuthill / M-D Pneumatics Competitor series and is also referred to as a 6008 CP. This unit is available in either a 2-lobe or 3-lobe design. This comparison document applies to the 2-lobe unit.

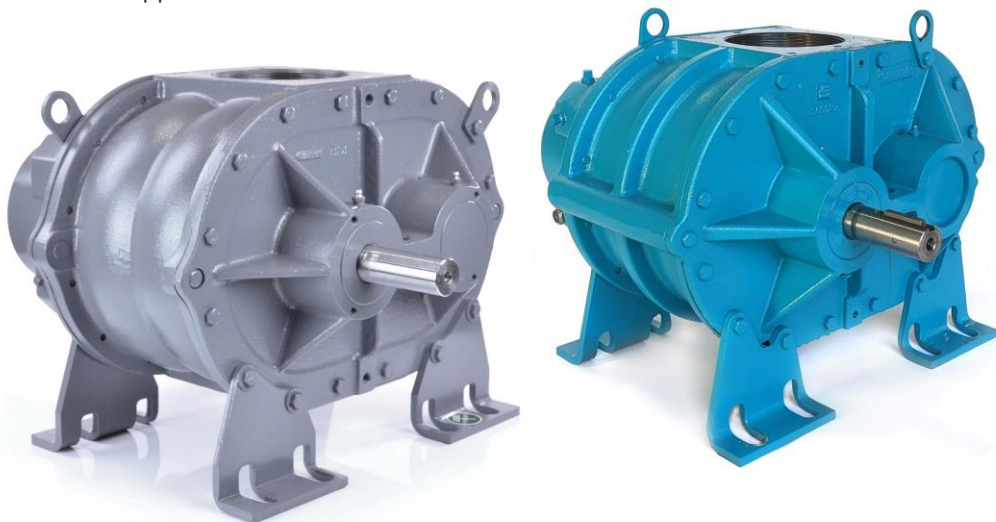

SPECIFICATIONS

	ROOTS 68 URAI	TUTHILL 6008 CP
Flow Range:	to 845 CFM	To 798 CFM
Max Δ Pressure:	14 psi	14 psi
Max Δ Vacuum:	16" Hg	16" Hg
Maximum RPM:	2350	2350
Minimum RPM:	636	700
Max ΔT:	240° F	240° F
Connection:	5" FPT	5" FPT
Shaft Diameter:	1 3/8"	1 3/8"
Unit Weight:	285 lb	310 lb

LUBRICATION

Both the 68 URAI and 6008 CP utilize oil lubrication on the gear end and grease on the drive end.

	68 URAI	6008 CP
Required Oil (Horizontal Unit)	52.1 oz	25.5 oz
Required Oil (Vertical Unit)	28.3 oz	16.9 oz
Grease Type	Aluminum Complex NLGI #2	Lithium Complex NLGI #2

Gear End Oil Lubrication

Blowers ship dry from factory and oil must be added before startup. Oil must be an industrial type non-detergent, rust inhibiting, anti-foaming oil of the correct viscosity. See your manual or contact us for assistance selecting the viscosity.

Drive End Grease Lubrication

These manufacturers use different types of grease which should not be mixed. If you plan to change to a different grease than the type that came in your blower, a full purge must be done.

CONFIGURATIONS

Both models feature movable mounting feet that allow the blower to be flipped into four different configurations. The manufacturer's part numbers are listed below.

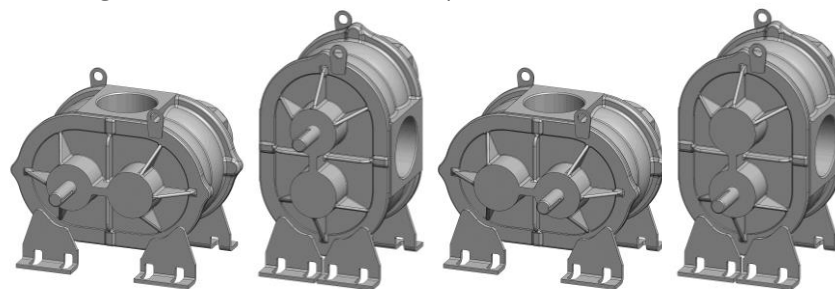

	LEFT HAND	TOP DRIVE	RIGHT DRIVE	BOTTOM DRIVE
68	6511702L	6511702T	6511702R	6511702B
6008	6008-A6L2CV1-A	6008-A6T2CV1-A	6008-A6R2CV1-A	6008-A6B2CV1-A

*Characters in the Tuthill model designations indicate materials, configurations, and special options.

Roots 68 URAI Blower

Dimensional Comparison with 6008 Competitor

While these models are considered drop-in equivalents, there are minor differences which should be considered for your situation.

SHAFT AND CONNECTIONS

Shaft size and connection size are the most important dimensions to compare. With these two models both measurements are the same.

To determine whether any changes to your piping or enclosure will be needed, take note of the placement of the connections (X,H) and the shaft (P,W).

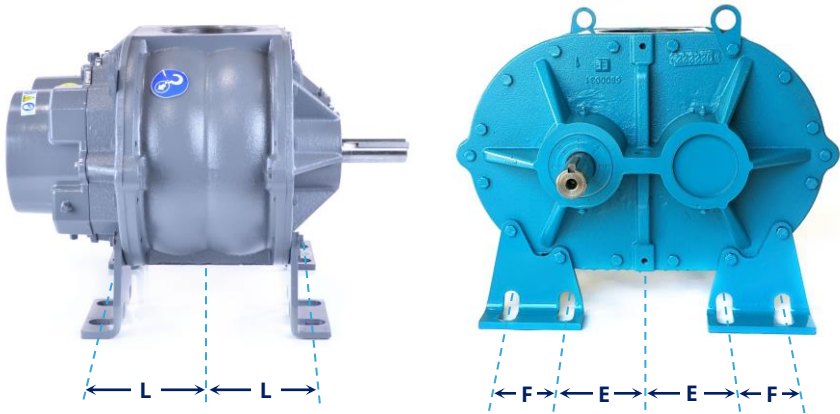
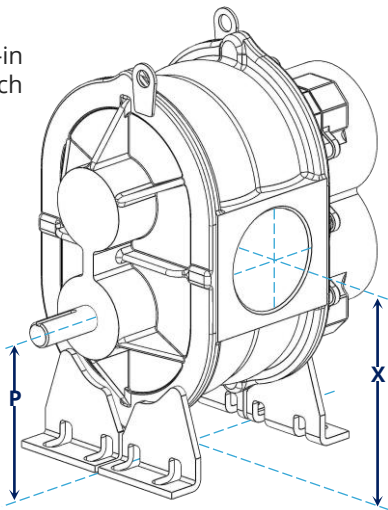

MOUNTING FEET

The placement of the bolt slots in the mounting feet is also important to consider. Both units feature universal mounting feet that can be moved to accommodate changes in configuration.

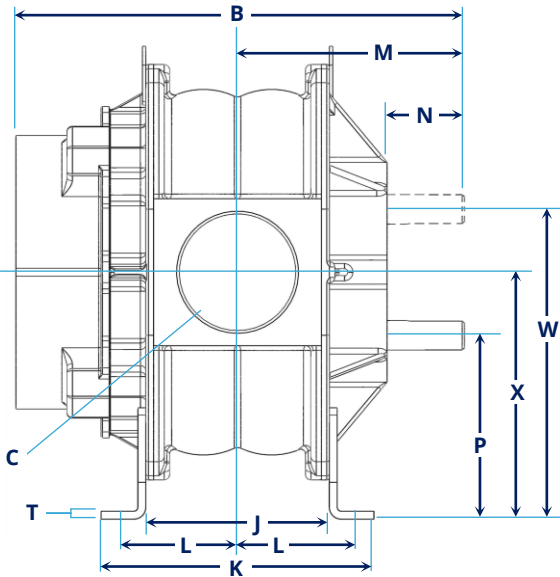
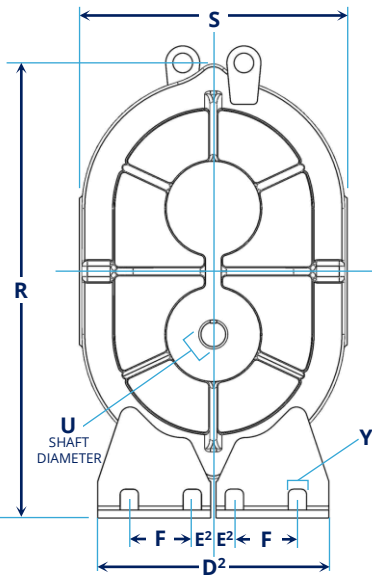
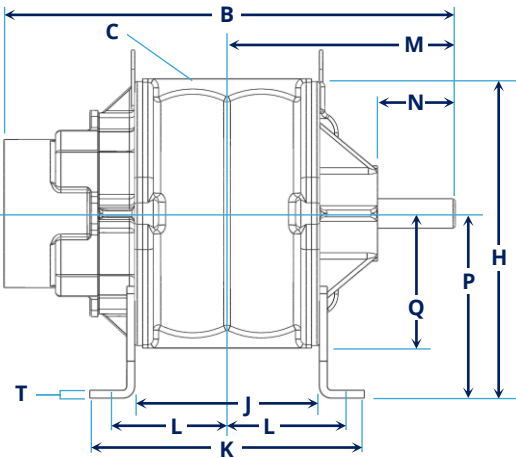
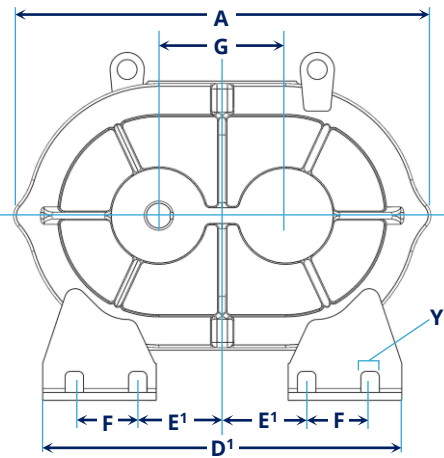

MAKE	MODEL	A	B	C	D1	D2	E1	E2	F	G	H	J	K	L	M	N	P	Q	R	S	T	U	W	X	Y
Roots	68 URAI	19.75	21.38	5" NPT	17	11	4	1	3	6	15.13	8.74	13	5.81	10.82	3.69	8.75	6.38	21.63	12.75	0.38	1.375	14.75	11.75	0.875
Tuthill	6008 CP	19.81	21.69	5" NPT	17.06	11	4.13	1.13	3	6	15	8.75	13	5.75	10.82	3.69	8.75	6.25	21.69	12.5	0.38	1.375	14.75	11.75	0.875

All measurements shown in inches

Roots 68 URAI

PRESSURE PERFORMANCE

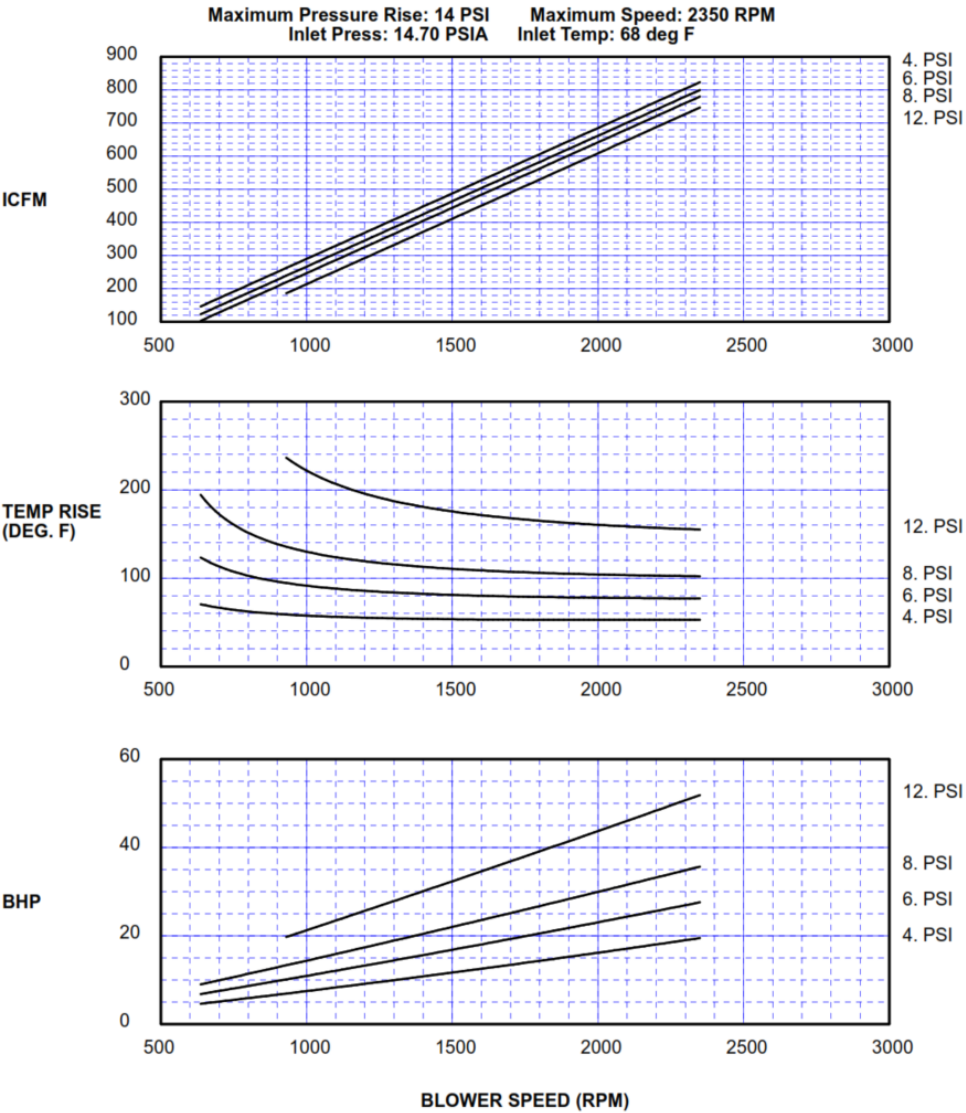

Tuthill 6008 CP Dual Lobe

PRESSURE PERFORMANCE

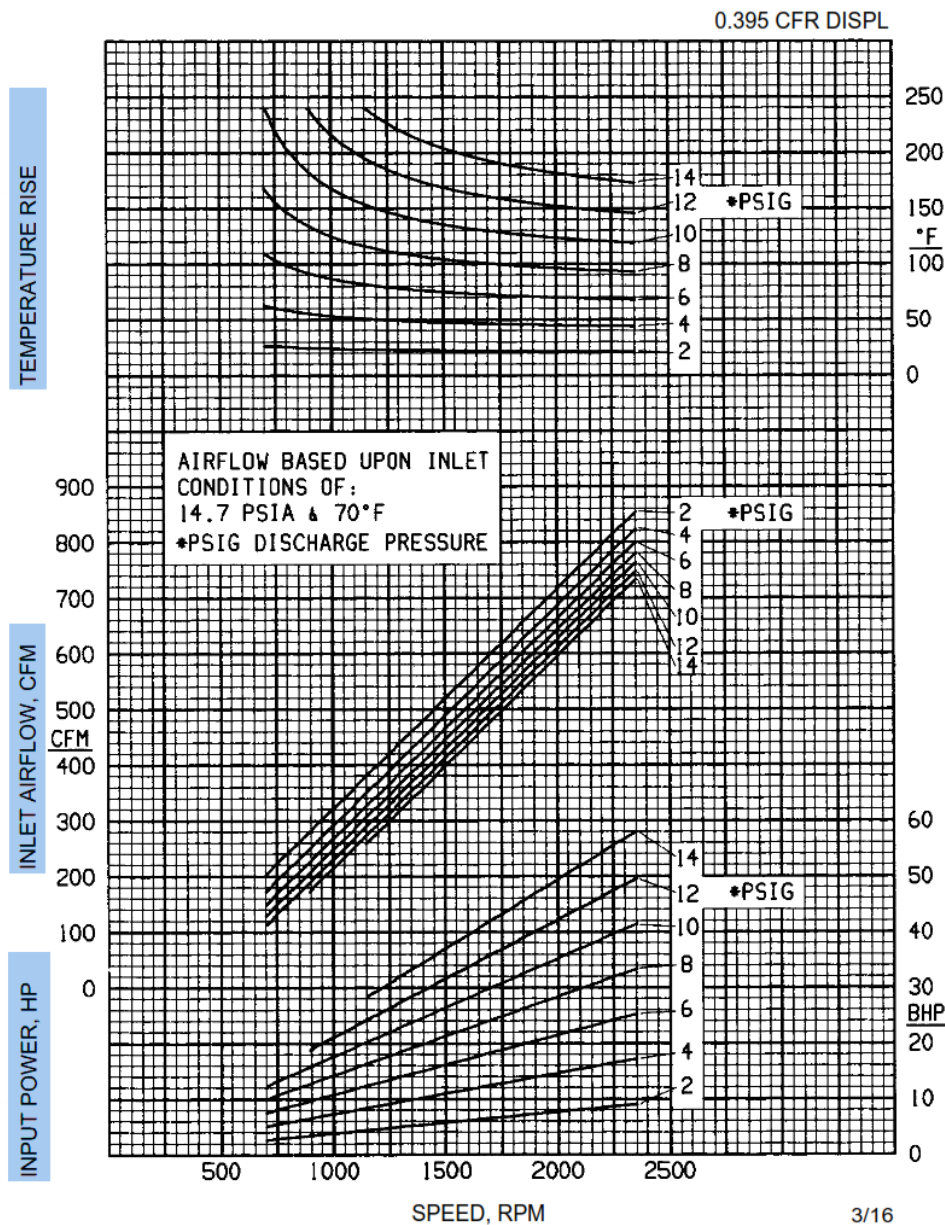

Roots 68 URAI

VACUUM PERFORMANCE

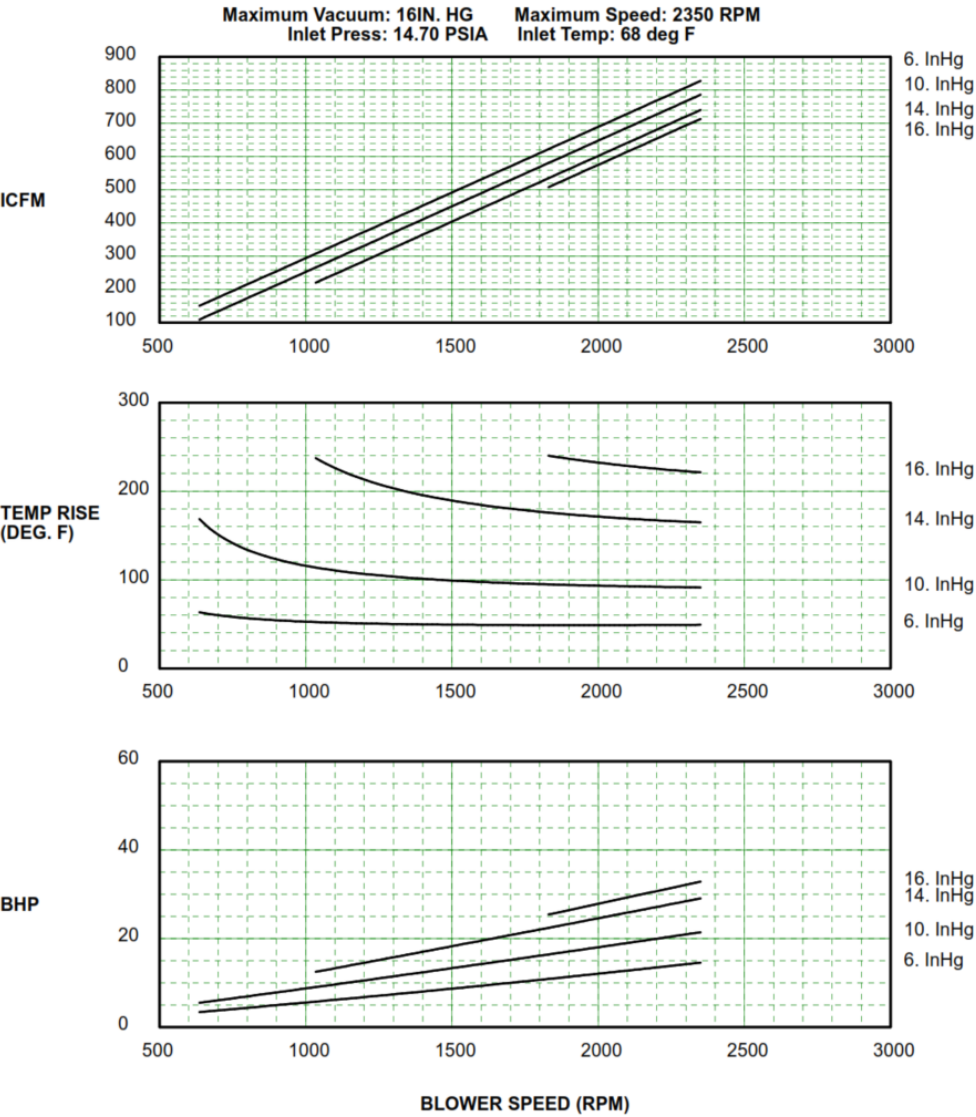

Tuthill 6008 CP Dual Lobe

VACUUM PERFORMANCE

