

Roots 711 URAI Blower

Comparison with Sutorbilt 7M Legend

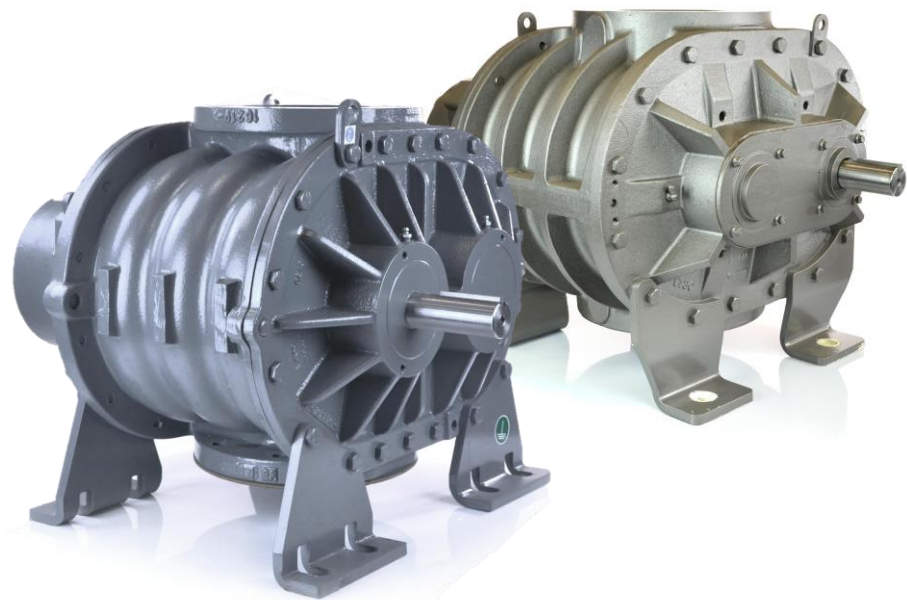

SPECIFICATIONS

	ROOTS 711 URAI	SUTORBILT 7M LEGEND
Flow Range:	to 1413 CFM	to 1383 CFM
Max Δ Pressure:	10 psi	10 psi
Max Δ Vacuum:	16" Hg	16" Hg
Maximum RPM:	2050	2050
Minimum RPM:	545	546
Max Δ T:	225° F	225° F
Connection:	6" Flange	6" Flange
Shaft Diameter:	1 9/16"	1 9/16"
Unit Weight:	530 lb	638 lb

LUBRICATION

Both the 711 URAI and 7M Legend utilize oil lubrication on the gear end and grease on the drive end.

	711	7M
Required Oil (Horizontal Unit)	59.5 oz	56 oz
Required Oil (Vertical Unit)	32.3 oz	27 oz
Grease Type	Aluminum Complex NLGI #2	Lithium Complex NLGI #2

Gear End Oil Lubrication

Blowers ship dry from factory and oil must be added before startup. Oil must be an industrial type non-detergent, rust inhibiting, anti-foaming oil of the correct viscosity. See your manual or contact us for assistance selecting the viscosity.

Drive End Grease Lubrication

These manufacturers use different types of grease which cannot be mixed. If you plan to change to a different grease than the type that came in your blower, a full purge must be done.

CONFIGURATIONS

Both models feature movable mounting feet that allow the blower to be flipped into four different configurations. The manufacturer's part numbers are listed below.

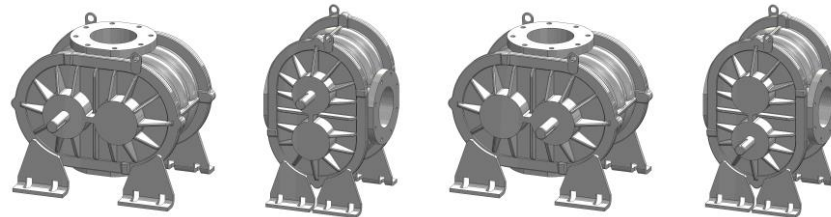

	LEFT HAND	TOP DRIVE	RIGHT DRIVE	BOTTOM DRIVE
711	6512102L	6512102T	6512102R	6512102B
7M	GAGMC*A	GAGMA*A	GAGMD*A	GAGMB*A

**The sixth character in the Sutorbilt part number indicates the series designation. As of this print, the current series is R. Previous series include P and L.*

Roots 711 URAI Blower

Dimensional Comparison with Sutorbilt 7M

While these are considered drop-in equivalents, there may be minor differences which should be considered for your situation.

MOUNTING FEET

Pictured here, the Roots 711 has two slots on each foot while the Sutorbilt 7M has a single slot centered in each foot. For the 7M use dimension E to find the distance to the center of the single mounting slot.

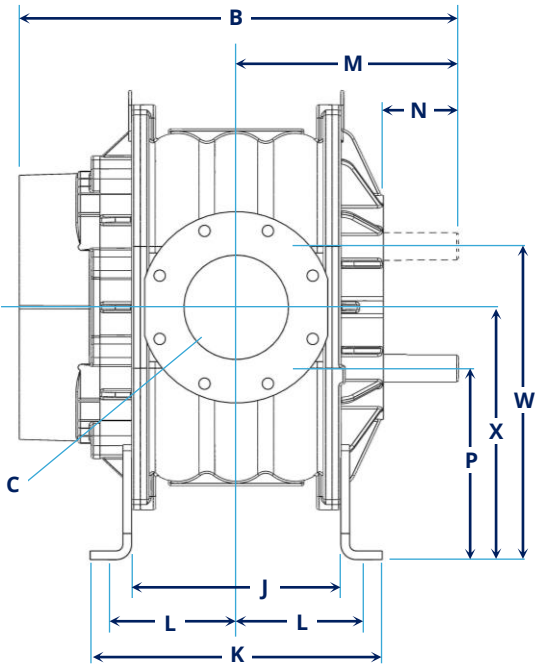
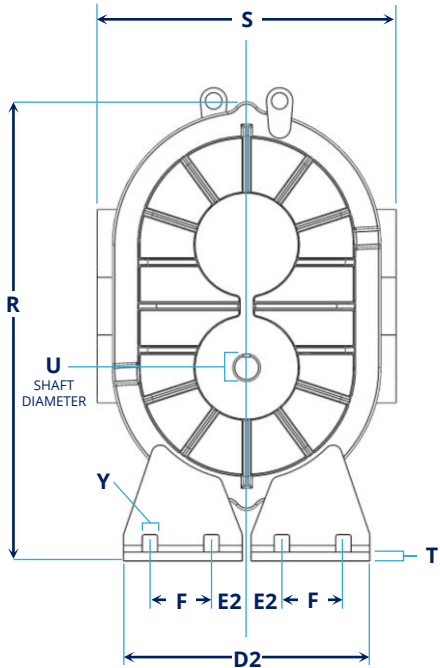
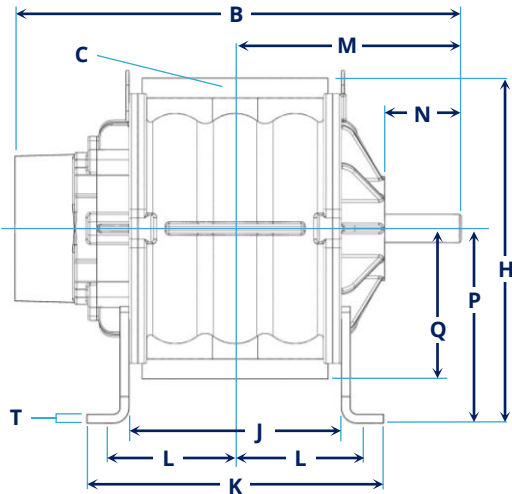
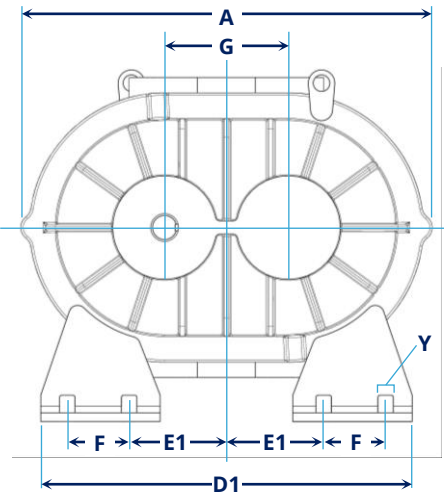
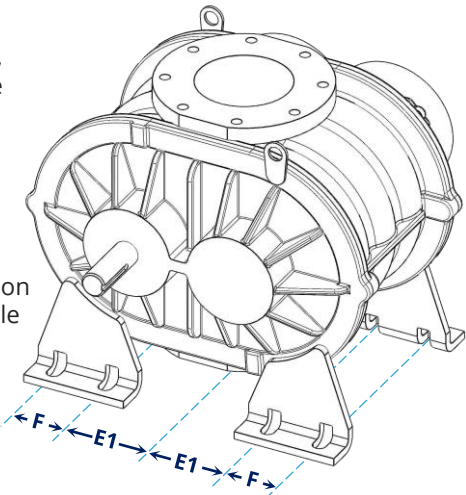

SHAFT AND CONNECTIONS

Shaft size and connection size are the most important dimensions to compare. With these two models these measurements are the same.

To determine whether any changes to your piping or enclosure will be needed, take note of the placement of the connections (X,H) and the shaft (P,W).

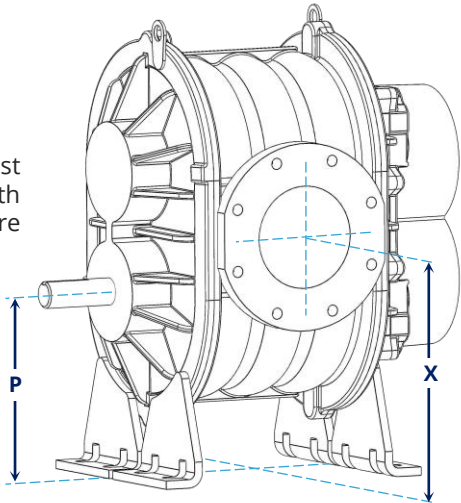

MAKE	MODEL	A	B	C	D1	D2	E1	E2	F	G	H	J	K	L	M	N	P	Q	R	S	T	U	W	X	Y
Roots	URAI 711	23.25	25.19	6" FLG	21	14	5.5	2	3.5	7	19.5	11.99	16.75	7.38	12.75	4.31	11	8.5	26.13	17	0.5	1.562	18	14.5	0.875
Sutorbilt	Legend 7M	22	26.53	6" FLG	15	15	5.5	5.5	N/A	7	19.5	11.24	17.5	7.38	12.75	3.21	11	8.5	25.5	17	0.5	1.562	18	14.5	0.75 X 1

All measurements shown in inches

Roots 711 URAI

PRESSURE PERFORMANCE

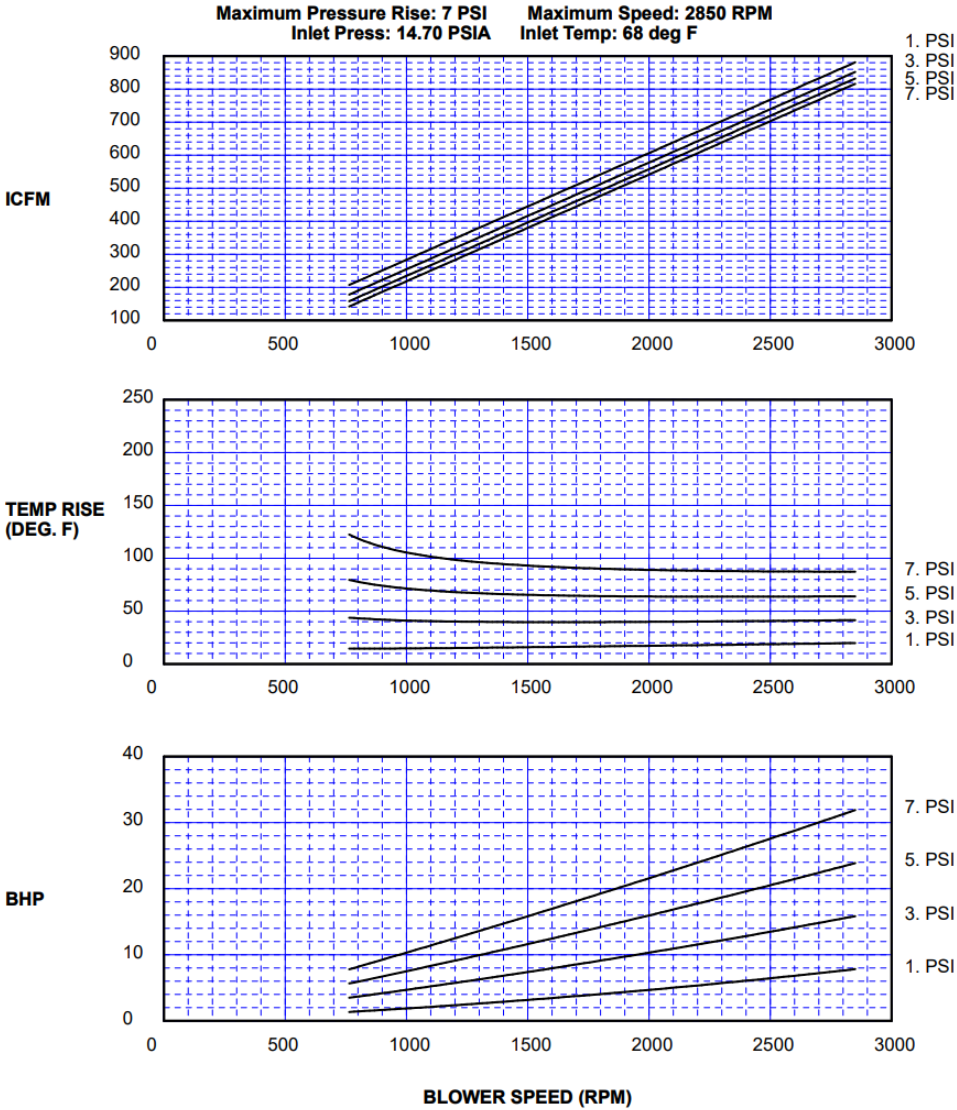

Sutorbilt 7M Legend

PRESSURE PERFORMANCE

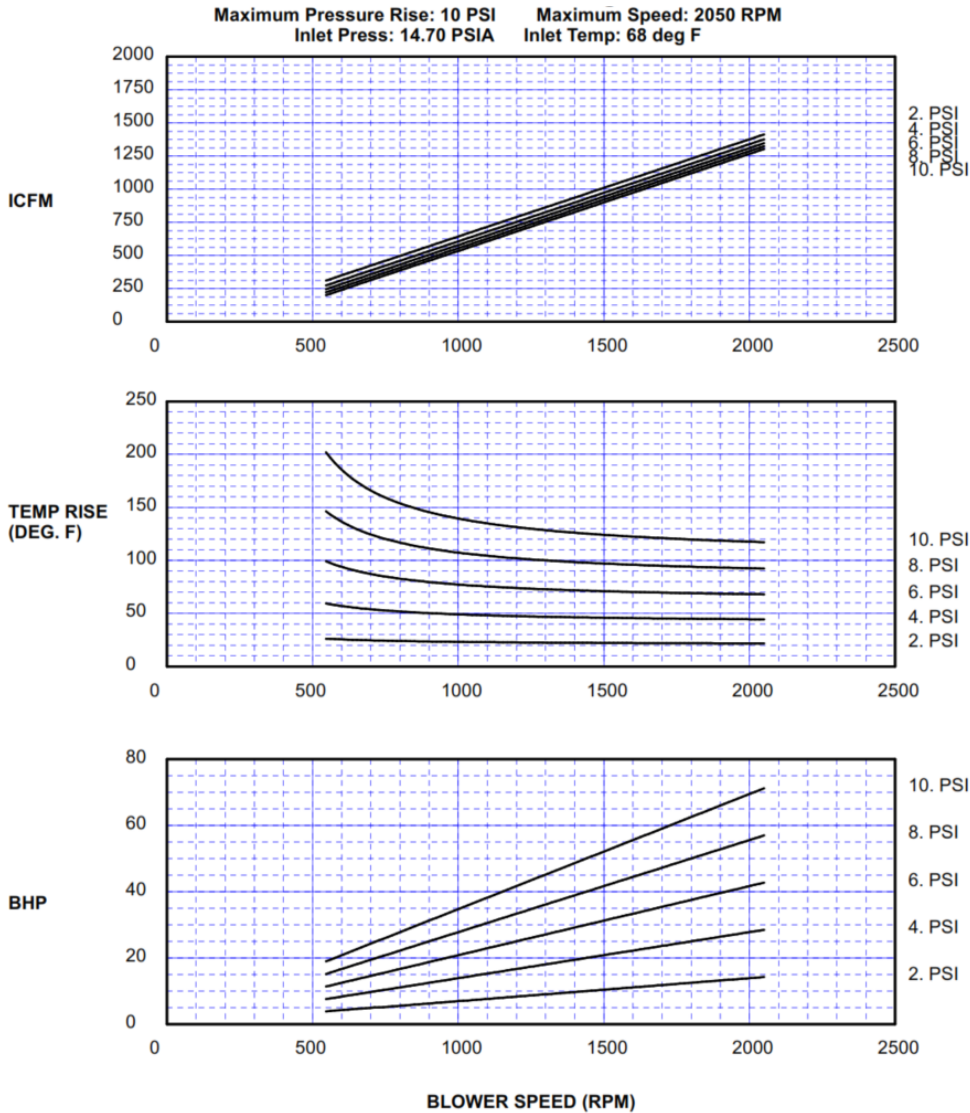

Roots 711 URAI

VACUUM PERFORMANCE

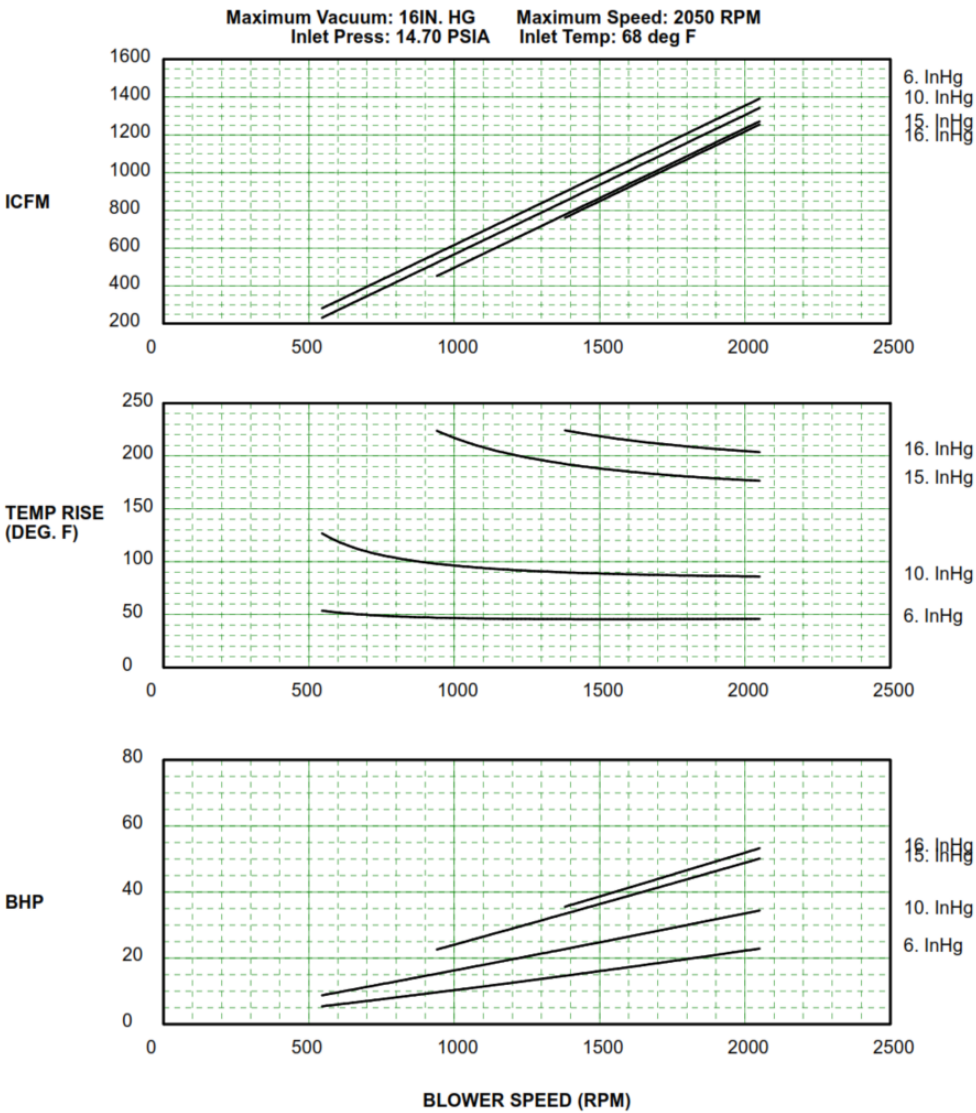

Sutorbilt 7M Legend

VACUUM PERFORMANCE

